

ABELL
SURVEYING & MAPPING
DELAVAN, WISCONSIN 53115
414-728-6737

CERTIFIED

LOT 3
(N 88°43'02" E 203.08')

N 88°43'01" E 202.98'

LOT 4

TIMBER TRAIL

200.00'
200.04'
(N 1°16'58" W)
66 FEET WIDE
(N 1°15'46" W)

200.07'
200.00'
(N 0°24'00" W)
S 0°23'47" E

SURVEY

MAP

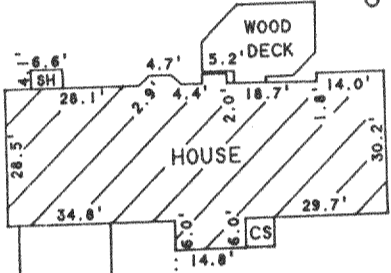

ADDITIONAL IRON PIPE FOUND 2.03' SOUTH AND 0.27' EAST OF CORNER

S 88°43'02" W 199.95' (200.00')

L I N N ROAD 49.50 FEET WIDE

NOTE: BEARINGS ARE REFERENCED TO CERTIFIED SURVEY MAP NO. 877.

ORDERED BY: PROFESSIONAL REALTY
1155 E. GENEVA STREET
DELAVAN, WI 53115

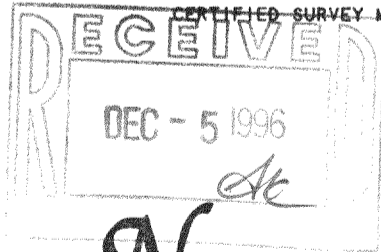

PLAT OF SURVEY OF

LOT 4, CERTIFIED SURVEY MAP NO. 877, LOCATED IN THE SOUTHWEST 1/4 OF SECTION 21, T2N, R16E, WALWORTH COUNTY, WISCONSIN.



SCALE 1" = 40'

LEGEND

- ⊙ - IRON PIPE FOUND
- CS - CONCRETE STOOP
- SH - SHED
- - UTILITY PEDS.
- () - RECORDED AS

I HEREBY CERTIFY THAT I HAVE SURVEYED THE ABOVE DESCRIBED PROPERTY AND THAT THE ABOVE MAP IS A TRUE REPRESENTATION THEREOF AND SHOWS THE SIZE AND LOCATION OF THE PROPERTY, ITS EXTERIOR BOUNDARIES, THE LOCATION OF ALL VISIBLE STRUCTURES AND DIMENSIONS OF ALL PRINCIPAL BUILDINGS THEREON, BOUNDARY FENCES, APPARENT EASEMENTS, ROADWAYS AND VISIBLE ENCROACHMENTS, IF ANY, TO THE BEST OF MY KNOWLEDGE AND BELIEF.

THIS SURVEY IS MADE FOR THE USE OF THE PRESENT OWNERS OF THE PROPERTY, AND ALSO THOSE WHO PURCHASE, MORTGAGE, OR GUARANTEE THE TITLE THERETO WITHIN ONE (1) YEAR FROM DATE HEREIN.

David F. Abell
DAVID F. ABELL
WISCONSIN REGISTERED LAND SURVEYOR, S-1596

September 9, 1996

DATE: September 9, 1996 JOB NUMBER - 96168
NOTE: THIS IS NOT A CERTIFIED COPY UNLESS SEALED.

FA-877-4

216-2327