

Foxtail Lane

Lot 7

(N88°44'41"E 101.75')
N88°45'34"E 101.66'

Arc=61.43'
Radius=65.00' Chord=N31°08'31"E 59.17'
(61.42')
(65.00')
(N31°08'05"E 59.16')

Lot 8
Tax Parcel
FCV 00008

0.523 Acre
22,770 Sq.Ft.

10' Wide Utility Easement
As shown on the plat of Country View Subdivision.

S1°15'19"E 197.72'
(S1°15'19"E 197.68')

Tax Parcel
FD 2300002

Lot 9

N25°37'10"W 242.24'
(S25°41'24"E 242.25')

15' Wide Drainage Easement
As shown on the plat of Country View Subdivision.

Found second pipe
7.39' N24°30'34"E
of corner.

S23°23'03"W 80.19'
(S23°17'05"W 80.03')

2" Pipe in
Pedestal

Tax Parcel
FD 2300006

Line as shown on survey dated
October 1, 1997 prepared by
Peter L. Bailey, American
Surveying Company, Inc.

Lot 7
Lake Prairie
Subdivision

Plat of Survey

of

Lot 8 of Country View Subdivision,

located in the Southwest 1/4 of Section 23, Town 2 North, Range
16 East, Town of Delavan, Walworth County, Wisconsin.

Surveyed for: **Josh Reed**
3482 Foxtail Lane
Delavan, Wisconsin. 53115

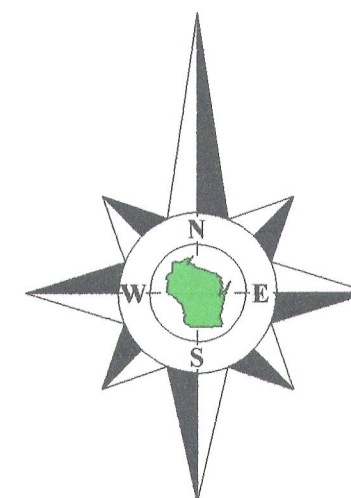

Bearings reference to the plat
of Country View Subdivision.

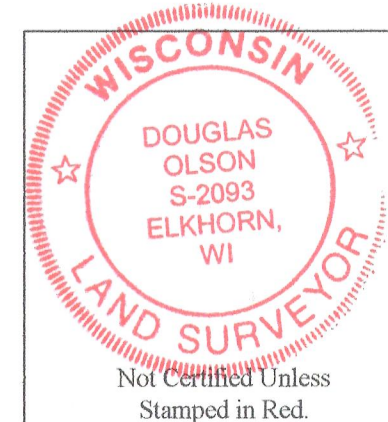

Notes:

- 1) This survey plat is not certified unless signed and sealed in red ink.
- 2) This survey is subject to Wisconsin lien laws. This Plat of Survey is the notice of intent to file lien. Lien waiver required.



Copyright 2010 by Jensen & Olson Land Surveying, LLC.

All rights reserved. No part of this survey plat may be reproduced or transmitted in any form by any means - graphic, electronic, or mechanical, including photocopying, tracing, or information storage and retrieval systems - without permission in writing from Douglas G. Olson, Jensen & Olson Land Surveying, LLC.

I, Douglas G. Olson, Wisconsin Registered Land Surveyor, do hereby certify that this survey was performed by me, or under my direction in full compliance with the owner's/agent's instructions and Chapter A-E 7 of the Wisconsin Administrative Code "Minimum Standards for Property Surveys"; and that this map is an accurate representation thereof to the best of my knowledge and belief.

Douglas G. Olson
Wisconsin Registered Land Surveyor - 2093

Survey Date: June 16, 2011.
Revisions:

Scale in Feet
1" = 20'
0' 10' 20' 40'

Jensen & Olson Land Surveying, LLC

45 South Wisconsin Street * P.O. Box 322 * Elkhorn, Wisconsin. 53121
Telephone: (262) 723-3434 * Facsimile: (262) 723-8044
Email: jensen.olson@elknet.net

Legend
Found Iron Pipe
() Recorded Information

Sheet 1 of 1 Sheets
Drawing Name: Carl (6-2011053-2011053)Plat.sc
Job Reference Number
2011.053

2011.053

FCV-8

216-4918