

ABERNATHY and ASSOCIATES

Kenneth B. Abernathy Jr.

Wisconsin Registered Land Surveyor S-1594

W4056 BRAY RD.
ELKHORN, WI. 53121
PHONE: (262) 723-4260 (OFFICE)
(262) 723-7209 (FAX)
Email: abernathy@elknet.net

PLAT OF SURVEY

LEGAL DESCRIPTION

LOTS 5 - 9 INCLUSIVE AND LOTS 15 - 19 INCLUSIVE OF BLOCK 3 OF SIDNEY ALLEN'S ADDITION TO THE VILLAGE OF ALLENS GROVE AS RECORDED IN VOL. 2 OF PLATS, PAGE 30, BEING LOCATED IN SECTION 31, TOWN 2 NORTH, RANGE 15 EAST, WALWORTH COUNTY, WISCONSIN, DESCRIBED MORE PARTICULARLY AS FOLLOWS: COMMENCE AT THE SOUTH 1/4 CORNER OF SAID SECTION 31; THENCE N 88°42'49" E ALONG THE SOUTH LINE OF SAID SECTION 355.90 FEET; THENCE N 0°45'00" W 165.00 FEET TO THE SOUTHWEST CORNER OF SAID LOT 19 AND THE POINT OF BEGINNING; THENCE CONTINUE N 0°45'00" W ALONG THE WEST LINE OF SAID BLOCK 3, 330.00 FEET TO THE NORTHWEST CORNER OF SAID LOT 15; THENCE N 88°42'49" E 264.00 FEET TO THE NORTHEAST CORNER OF SAID LOT 9; THENCE S 0°45'00" E 330.00 FEET TO THE SOUTHEAST CORNER OF SAID LOT 5; THENCE S 88°42'49" W 264.00 FEET TO THE POINT OF BEGINNING. SAID PARCEL CONTAINS 2.00 ACRES OF LAND MORE OR LESS.

PARK STREET (UNIMPROVED)

UNIMPROVED

JOHN STREET

ORDERED BY: ELLIE OLESTON
SKANDIA REALTY, INC.
822 EAST GENEVA STREET
DELAVAN, WI 53115



SCALE: 1 INCH = 40 FEET

Legend

- ⊕ FOUND IRON PIPE
- ⊙ FOUND IRON ROD
- FOUND BRASS CAPPED MONUMENT
- FOUND CONCRETE MONUMENT
- CHISEL CUT IN CONCRETE
- SET IRON ROD, 24" LONG, WEIGHING 1.5 LBS./LINEAL FT., 3/4" DIA.
- SET IRON ROD, 30" LONG, WEIGHING 4.5 LBS./LINEAL FT., 1-11/16" DIA.
- (xx) RECORDED AS DIMENSION
- - - EXISTING FENCE

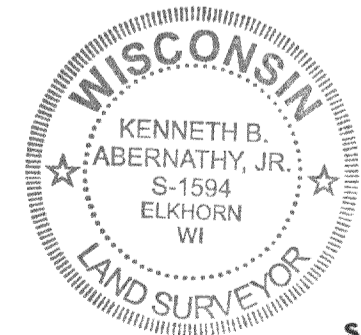

SCALE: 1" = 40 FEET

I hereby certify that the above described property has been surveyed by me or under my direction and that the above map is a true representation thereof and shows the size and location of the property, its exterior boundaries, the location of all visible structures and dimensions of all principal buildings thereon, boundary fences, apparent easements, roadways and visible encroachments, if any.
This survey is made for the use of the present owners of the property, and also those who purchase mortgage, or guarantee the title thereto within one year from date hereof.

Kenneth B. Abernathy, Jr.

KENNETH B. ABERNATHY, JR.
WISCONSIN REGISTERED LAND SURVEYOR,
S-1594

Date: MARCH 31, 2004 Job No. 99.312

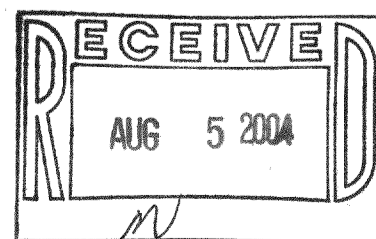

SOUTH 1/4 CORNER
SEC. 31-2-15

355.90'
S 88°42'49" W

SOUTH LINE SEC. 31-2-15