

PLAT OF SURVEY
OF

LOT 9 AND THE WEST 50 FEET OF LOT 8, BLOCK 1, ROSE NIPPERSINK GARDENS, A SUBDIVISION LOCATED
IN SECTION 24, T. 1 N., R. 18 E. OF THE 4TH P.M., TOWNSHIP OF BLOOMFIELD, WALWORTH COUNTY, WI.

I HEREBY CERTIFY THAT I HAVE SURVEYED THE
LAND DESCRIBED ABOVE AND THAT THE PLAT
DRAWN HEREON IS A CORRECT REPRESENTATION
OF SAID SURVEY.

RE-SURVEYED 10-2-90

John F. Degen 6-10-81
JOHN F. DEGEN, LAND SURVEYOR #242
589 N. PINE ST., BURLINGTON, WIS.

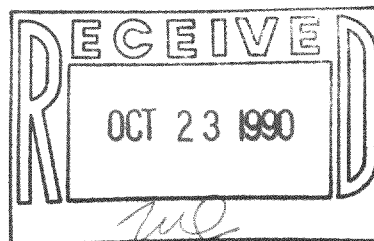

SCALE 1" = 30'

o = IRON PIPE STAKE SET. 1981

o = IRON PIPE STAKE FOUND.

BEARINGS ARE THOSE OF RECORDED PLAT.

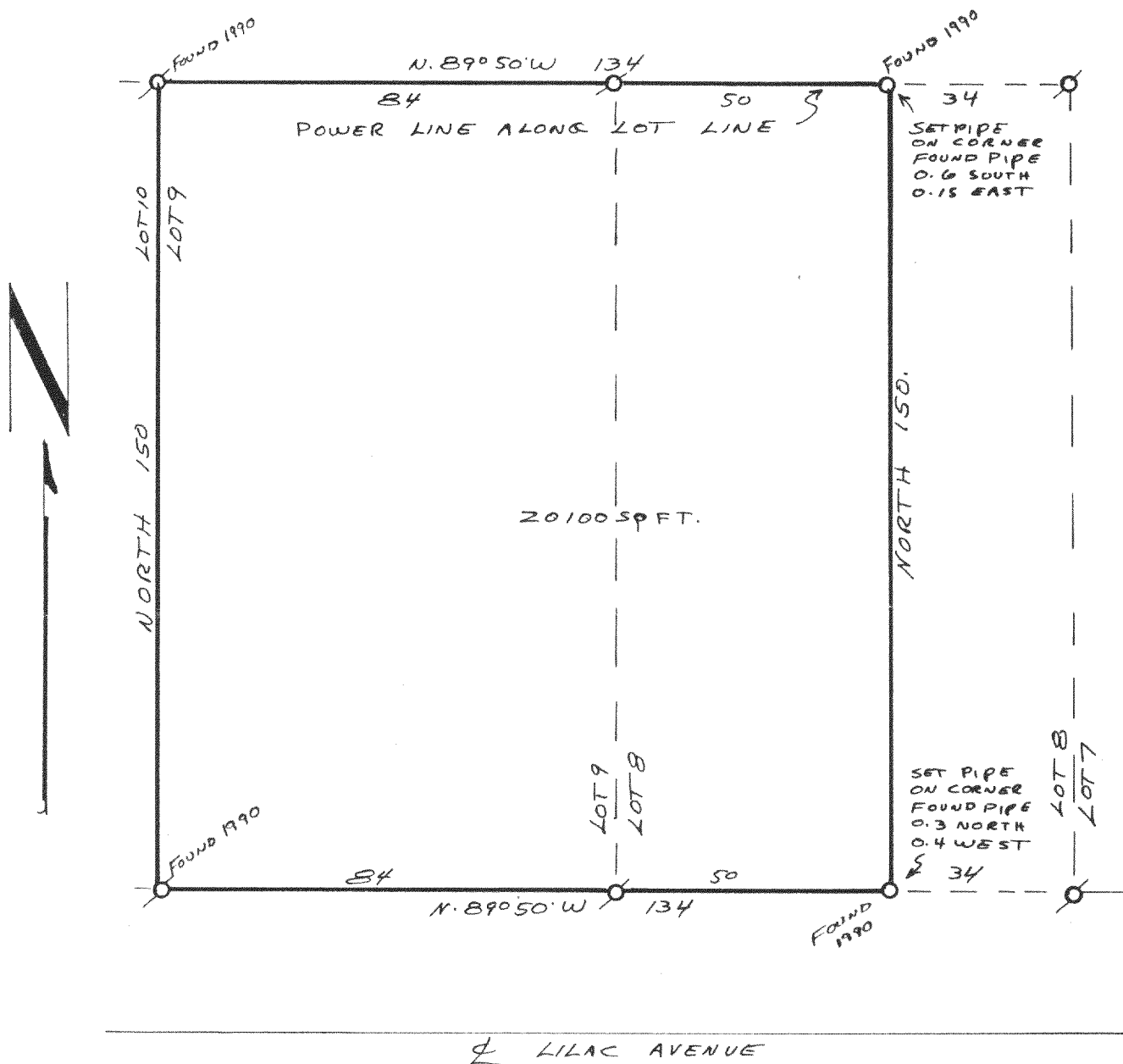

TAX KEY #

MRNG 00007

118-920

6-D-4 #16