

HAROLD H. KOLB
 REGISTERED PROFESSIONAL LAND SURVEYOR
 LAKE GENEVA, WISCONSIN

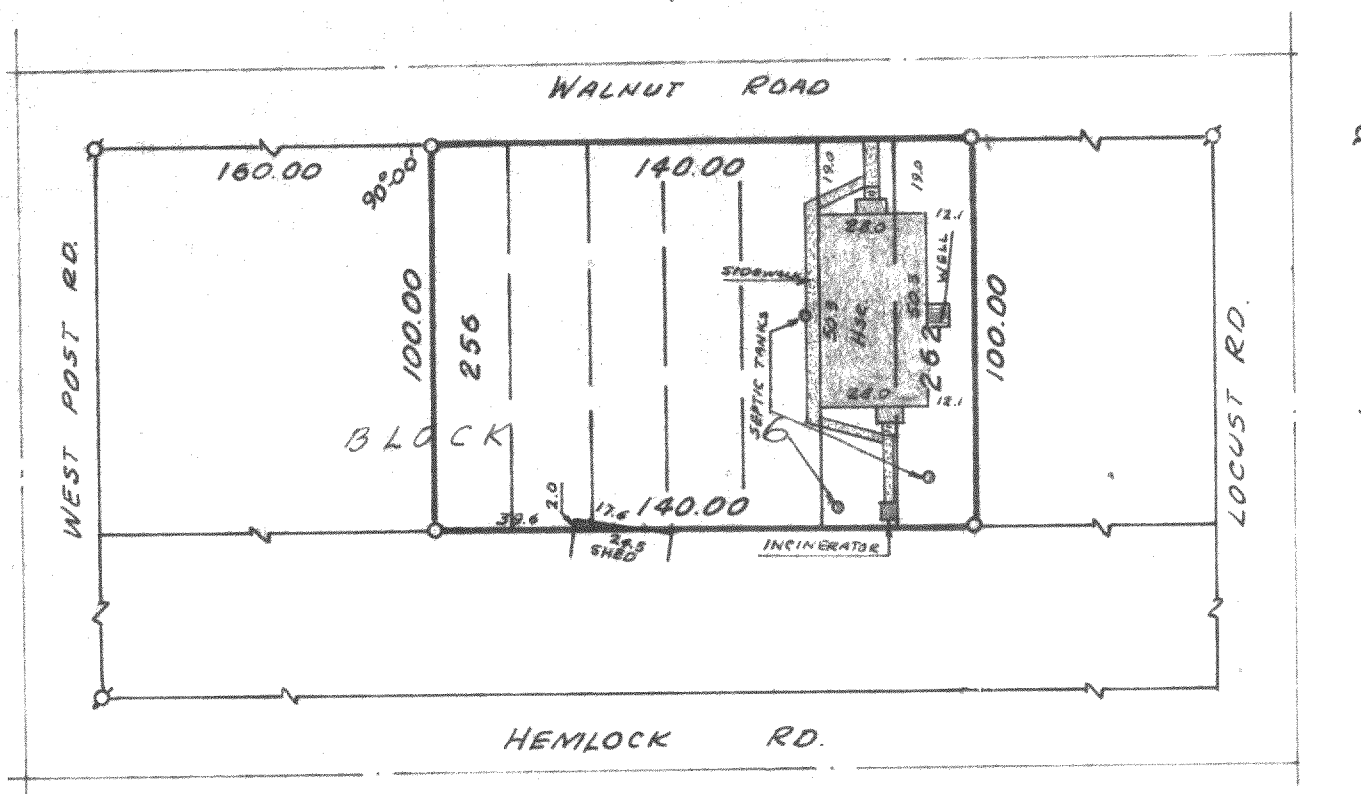

PLAT OF SURVEY OF

Lots 256 to 262, Block 6, Section 1
 of Pell Lake Subd., Walworth County,
 Wisconsin

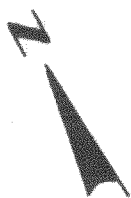

LEGEND

- ⊘ - IRON PIPE FOUND
- - IRON PIPE PLACED
- - CONCRETE MONUMENT
- x - SPIKE

SCALE - 1" = 50'

I, HAROLD H. KOLB, DO HEREBY CERTIFY THAT I HAVE
 SURVEYED THE PROPERTY HEREON DESCRIBED ACCORDING
 TO THE OFFICIAL RECORDS, AND THAT THE PLAT HEREON
 IS A CORRECT REPRESENTATION OF THE LOT LINES AND THE
 PRINCIPLE LINES OF THE BUILDINGS THEREON.

Harold H. Kolb

HAROLD H. KOLB

WISCONSIN REGISTERED LAND SURVEYOR, S-187

DATE OCT. 28, 1968

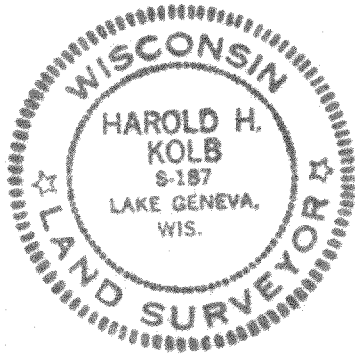

118-248

1-18-114