

PLAT OF SURVEY OF

A parcel of land located in the golf Course as shown on the plat of PELL LAKE HIGHLANDS, Town of Bloomfield, County of Walworth, State of Wisconsin, bounded and described as follows: Commencing at the intersection of the north line of Birchwood Road and the west line of Hillside Boulevard; thence North 88 degrees 45 minutes West 950 feet to the place of beginning; thence continue North 88 degrees 45 minutes West 184.66 feet; thence North 00 degrees 32 minutes East 120 feet; thence South 88 degrees 45 minutes East 183.54 feet; thence South 120 feet to the place of beginning.

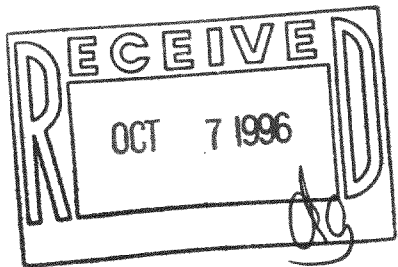
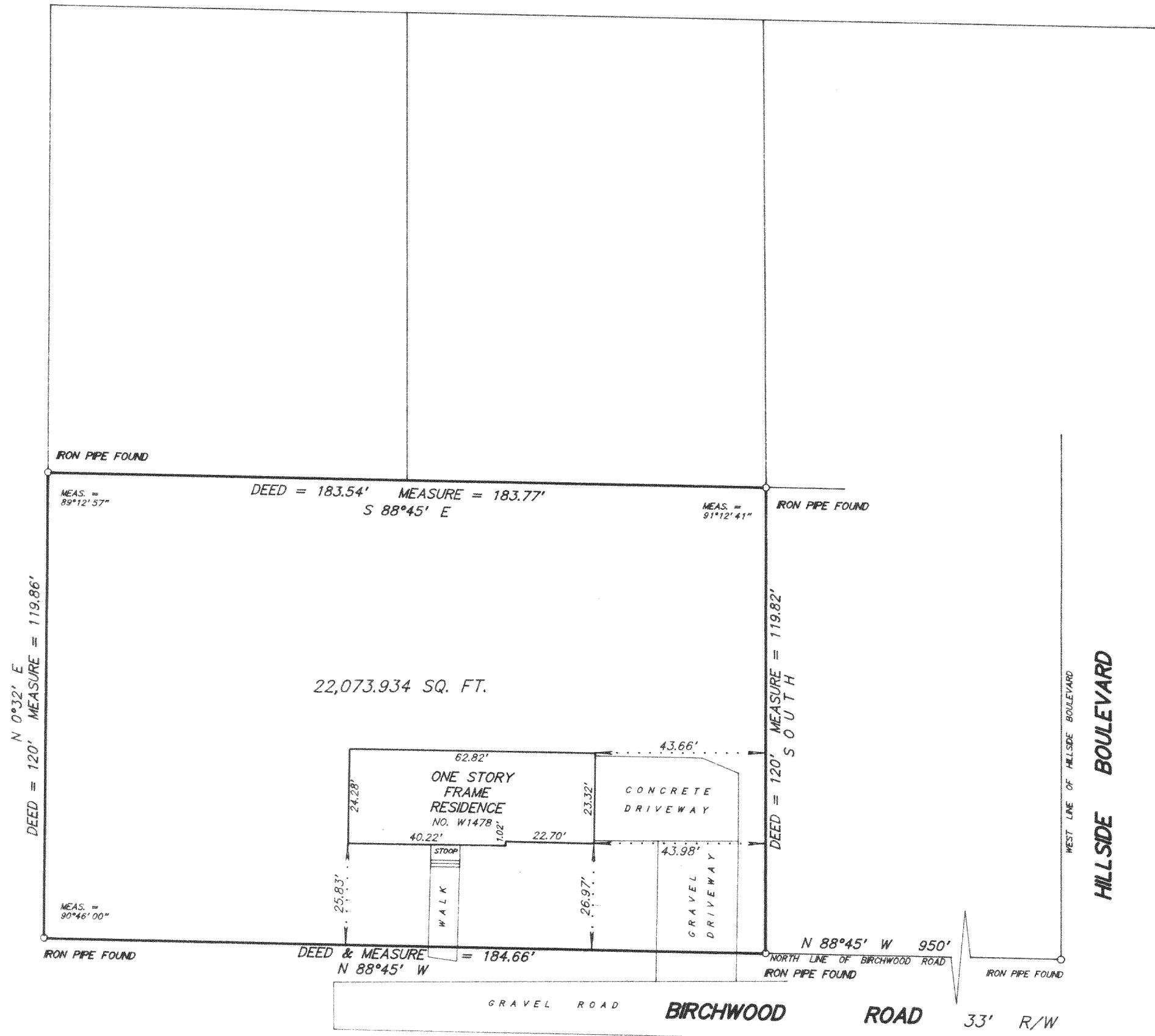

SCALE 1 inch = 30 feet
ORDERED BY C.Gene Simons / RE/MAX - Geneva Realty
JOB NO. 96233

I hereby certify that I have surveyed the above described property and the above plat is a true representation thereof and shows the size and location of the property, its exterior boundaries, the location and dimensions of all visible structures thereon, boundary fences, apparent easements and roadways and visible encroachments, if any.

This survey is made for the exclusive use of the present owners of the property, and also those who purchase, mortgage, or guarantee the title thereto within one year from the date hereof.

Dated at Bassett, Wisconsin this _____ day of _____ 1996.

Mark A. Bolender
Wisconsin Registered Land Surveyor S - 1784

MPLH-358
118-1587