

West 1/4 Corner  
Section 10-1-17  
N. 207,859.76  
E. 2,408,899.98

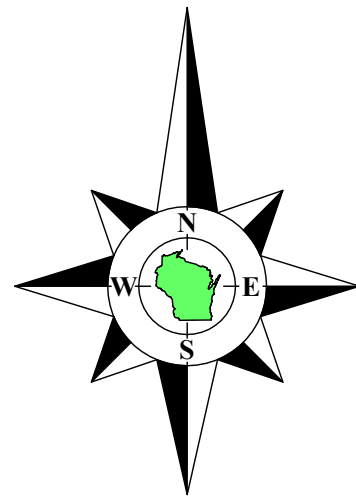

Bearings referenced to the West line of the Southwest 1/4 of Section 10-1-17, recorded as N01°20'04"W in the Wisconsin State Plane Coordinate System, South Zone, (NAD-27).

Coordinates are referenced to the Wisconsin State Plane Coordinate System, South Zone, (NAD-27).

Surveyed for:

**Antonette Drury**  
227 East Delaware Place, Unit 11C  
Chicago, Illinois. 60611

# Plat of Survey

of

## Lots 7 & 8 in Block 7 of Genevista,

a subdivision recorded June 26, 1912 in Vol. 6 of Plats of Walworth County on Page 99 as Document Number 193149 and located in the Southwest 1/4 of the Southwest 1/4 of Section 10, Town 1 North, Range 17 East, Town of Linn, Walworth County, Wisconsin.

West line of the Southwest 1/4 of Section 10-1-17  
N1°20'04"W 2638.10'  
Recorded as N1°20'04"W 2638.06' State Plane

890.17'

111.96'  
(112')

Lot 5

Lot 6

N1°13'09"W 150.00'

Found Lath  
0.3' W. of line

Fence 0.9'  
E. of line

Timber

Walk

Wood  
Fence

Latice

8.5'

8.0'

16.1'

38.4'

0.7'

0.6'

11.6'

23.2'

30.4'

47.2'

12.2'

24.2'

56'

115.87'

(56')

(60.4')

Found Pipe  
Down 1.0'  
Leans West

Lot 10

Alley  
(16' Wide)

Oakrest Avenue  
(50' Wide)

N88°28'41"E 112.20'

Parking  
(56')

Overhead Wires

Overhead Wires

Guy

House  
W3613

Patio

Lot 7

Patio

**Tax Parcel**  
**IGV 00037B**

0.386 Acres  
16,815 Sq.Ft.

Lot 8

Lot 9

S01°08'27"E 150.01'

(150')

Fence 0.2'  
W. of line

Chain Link Fence

Fence 0.1'  
W. of line

Block 7

S88°29'08"W 112.00'

Alley  
(16' Wide)

Copyright ©2025 by Olson Land Surveying, LLC.

All rights reserved. No part of this survey plat may be reproduced or transmitted in any form by any means - graphic, electronic, or mechanical, including photocopying, tracing, or information storage and retrieval systems - without permission in writing from Douglas G. Olson, Olson Land Surveying, LLC.

I hereby certify that I have surveyed the above described property in compliance with Chapter A-E 7 of the Wisconsin Administrative Code and that the map hereon is correct to the best of my professional knowledge and belief and shows the size and location of the property, its exterior boundaries, the location and dimensions of all visible structures thereon, boundary fences, apparent easements and roadways and visible encroachments, if any.

This survey is made for the exclusive use of the present owners of the property, and also those who purchase, mortgage or guarantee title thereto, within one year from the date hereof.

Douglas G. Olson  
Wisconsin Professional Land Surveyor - 2093

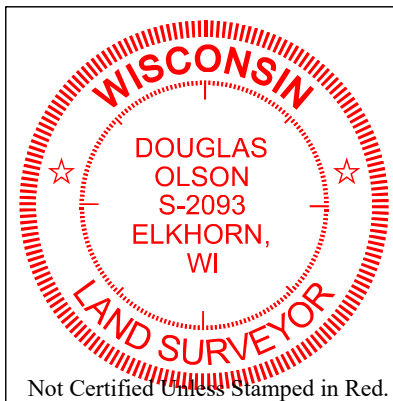

### Notes:

- This Plat of Survey is not certified unless signed and sealed in red ink.
- This survey is subject to Wisconsin lien laws. This Plat of Survey is the notice of intent to file lien. Lien waiver required.
- The Survey Date shown on this Plat of Survey is the completion date of the field work.

Southwest Corner  
Section 10-1-17  
N. 205,222.43  
E. 2,408,961.42

Survey Date: September 22, 2025.

Revisions:

Scale in Feet  
1" = 20'

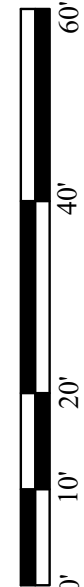

45 South Wisconsin Street | P.O. Box 322  
Elkhorn, Wisconsin. 53121  
Telephone: (262) 723-3434  
Facsimile: (262) 723-8044  
Email: doug@olsonsurveying.com  
Website: www.olsonsurveying.com

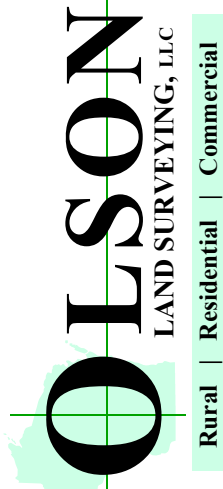

Legend of Symbols & Abbreviations	
Found County Section Corner	W North
Found Iron Pipe	S South
Found Iron Rod	E East
Set Iron Pipe, 1" dia.	N North
Recorded Information	In Bearings
Utility Pole	Minutes
Utility Pole	Seconds
Asphalt Surface	Distances
Gravel Surface	In Feet
Gravel Surface	In Feet
Brick Pavers	Inches

Sheet 1 of 1 Sheets

Drawing Name:

Job Reference Number

2025.109

2025.109