

of

a subdivision recorded July 31, 1915 in Vol. 6 of Plats of Walworth County on Page 149 as Document Number 205249 and located in Government Lot 2 in the Northeast 1/4 of Section 18, Town 1 North, Range 17 East, Town of Linn, Walworth County, Wisconsin.

Bearings referenced to the straight line between the Center 1/4 corner and the East 1/4 corner of Section 18-1-17, recorded as N89°30'42"E in the Wisconsin State Plane Coordinate System, South Zone, (NAD-27).

Coordinates are referenced to the Wisconsin State Plane Coordinate System, South Zone, (NAD-27).

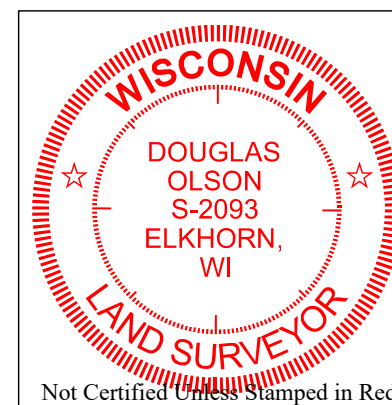

Notes:

- 1) This Plat of Survey is not certified unless signed and sealed in red ink.
- 2) This survey is subject to Wisconsin lien laws. This Plat of Survey is the notice of intent to file lien. Lien waiver required.
- 3) The Survey Date shown on this Plat of Survey is the completion date of the field work.

Copyright © 2024 by Olson Land Surveying, LLC.

All rights reserved. No part of this survey plat may be reproduced or transmitted in any form by any means - graphic, electronic, or mechanical, including photocopying, tracing, or information storage and retrieval systems - without permission in writing from Douglas G. Olson, Olson Land Surveying, LLC.

I hereby certify that I have surveyed the above described property in compliance with Chapter A-E 7 of the Wisconsin Administrative Code and that the map hereon is correct to the best of my professional knowledge and belief and shows the size and location of the property, its exterior boundaries, the location and dimensions of all visible structures thereon, boundary fences, apparent easements and roadways and visible encroachments, if any.

This survey is made for the exclusive use of the present owners of the property, and also those who purchase, mortgage or guarantee title thereto, within one year from the date hereof.

Douglas G. Olson
Wisconsin Professional Land Surveyor - 2093

East 1/4 Corner
Section 18-1-17.
N. 202,349.48
E. 2,398,457.54

Center 1/4 Corner
Section 18-1-17.
N. 202,327.01
E. 2,395.820.88

South 1/8 Corner of
the Northeast 1/4 of
Section 18-1-17.

N89°30'42"E 2636.84'
recorded as(N89°30'42"E 2636.76')State Plane

Survey Date: October 25, 2024.
Revisions: No. 1 – Proposed House & Parking

Scale in Feet
1" = 10'



45 South Wisconsin Street | P.O. Box 322
Elkhorn, Wisconsin. 53121
Telephone: (262) 723-3434
Facsimile: (262) 723-8044
Email: doug@olsonsurveying.com
Website: www.olsonsurveying.com



OLSON
LAND SURVEYING, LLC

Found County Section Corner Found Iron Pipe Found Footing Set Iron Pipe 1" dia. Recorded Information Utility Pole Utility Pedestal Concrete Curb Asphalt Surface Gravel Surface Brick Pavers	N North S South E East W West B Bearings in Feet ' Minutes " Seconds In Distances Feet " Seconds
--	--

Sheet 1 of 1 Sheets

Drawing Name:

Job Reference Number

2024.106

2024.106