

Northwest Corner  
Section 15-1-17  
N. 205,222.43  
E. 2,408,961.42

# Plat of Survey

of

## Lots 7 & 10 in Block 4 of Lake Geneva Terrace,

a subdivision recorded May 26, 1924 in Vol. 7 of Plats of Walworth County on Page 142 as Document Number 245191 and located in the Northwest 1/4 of the Northwest 1/4 of Section 15, Town 1 North, Range 17 East, Town of Linn, Walworth County, Wisconsin.

Surveyed for: **Ron Hendrickson**  
N1666 Linn Road  
Lake Geneva, Wisconsin. 53147

Lot 5

Lot 8

Bearings referenced to the West line of the Northwest 1/4 of Section 15-1-17, recorded as N1°23'01"W in the Wisconsin State Plane Coordinate System, South Zone, (NAD-27).

Coordinates are referenced to the Wisconsin State Plane Coordinate System, South Zone, (NAD-27).

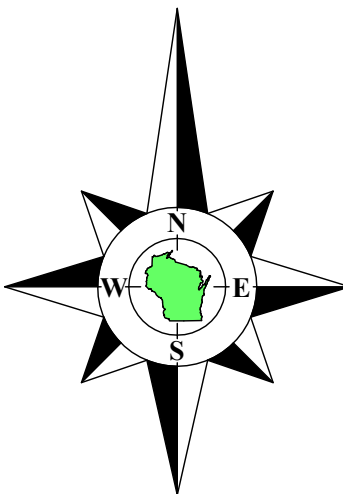

Linn Road

Tax Parcel  
ILGT 00013B

0.597 Acre  
26,006 Sq.Ft.

Lot 10  
Proposed Garage

Proposed 24' Wide Driveway

Proposed Silt Fence

Proposed  
Dirt  
Stockpile

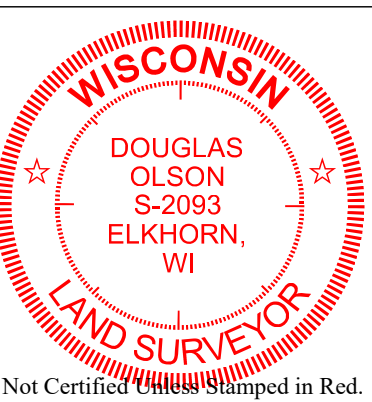

### Notes:

- This Plat of Survey is not certified unless signed and sealed in red ink.
- This survey is subject to Wisconsin lien laws. This Plat of Survey is the notice of intent to file lien. Lien waiver required.
- The Survey Date shown on this Plat of Survey is the completion date of the field work.

Copyright © 2024 by Olson Land Surveying, LLC.

All rights reserved. No part of this survey plat may be reproduced or transmitted in any form by any means - graphic, electronic, or mechanical, including photocopying, tracing, or information storage and retrieval systems - without permission in writing from Douglas G. Olson, Olson Land Surveying, LLC.

I hereby certify that I have surveyed the above described property in compliance with Chapter A-E 7 of the Wisconsin Administrative Code and that the map hereon is correct to the best of my professional knowledge and belief and shows the size and location of the property, its exterior boundaries, the location and dimensions of all visible structures thereon, boundary fences, apparent easements and roadways and visible encroachments, if any.

This survey is made for the exclusive use of the present owners of the property, and also those who purchase, mortgage or guarantee title thereto, within one year from the date hereof.

Douglas G. Olson  
Wisconsin Professional Land Surveyor - 2093

Sheet 1 of 1 Sheets

Drawing Name:

Job Reference Number  
2024.096

### Legend of Symbols & Abbreviations

- Found County Section Corner
- Found Iron Pipe
- Found Iron Rod
- Set Iron Pipe, 1" dia.
- Recorded Information
- Utility Pole
- Utility Pedestal
- Concrete Cover
- Asphalt Surface
- Flag Set by Owner
- Catch Basin
- Concrete Surface
- N North
- S South
- E East
- W West
- In Bearings
- Degrees
- Minutes
- Seconds
- In Distances
- Feet
- Inches



45 South Wisconsin Street | P.O. Box 322  
Elkhorn, Wisconsin. 53121  
Telephone: (262) 723-3434  
Facsimile: (262) 723-8044  
Email: doug@olsonsurveying.com  
Website: www.olsonsurveying.com

Scale in Feet  
1" = 20'



Survey Date: October 1, 2024.

Revisions: No. 1 - Proposed Garage & Driveway

2024.096