

Viewcrest Drive  
(60' Wide)

# Plat of Survey

of  
Lots 20-22 in Block 4 of Maple Hills Subdivision A,

located in the Northwest 1/4 of the Southeast 1/4 of Section 18, Town  
1 North, Range 17 East, Town of Linn, Walworth County, Wisconsin.

Lot 23

Surveyed for: **Patrick Kinnerk**  
N1420 Maple Hills Drive  
Fontana, Wisconsin. 53125

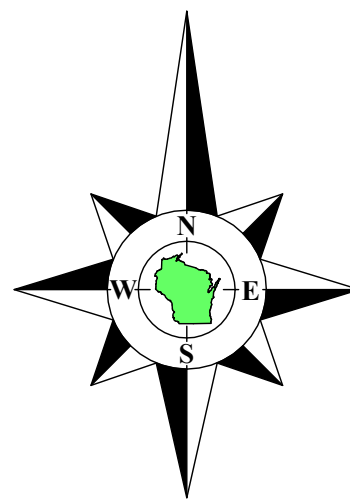

Bearings referenced to the East line of Bird Lane,  
recorded as N1°20'00"E on the plat of Maple Hills  
Subdivision A.

record as(N88°40'W 108')  
**S88°39'10"E 107.94'**

N1°17'34"E 47.72'

Lot 24

Lot 25

Lot 26

Lot 27

**Tax Parcel  
IMH 00074**

0.297 Acre  
12,956 Sq.Ft.

S1°17'34"W 119.77'  
recorded as(N1°20'E 120')

Maple Hills Drive  
(50' Wide)

recorded as(N1°20'E 120')  
**N1°19'53"E 120.20'**

recorded as(N1°20'E 927.75')  
**N1°19'53"E 926.20'**

**N88°52'50"W 108.02'**  
record as(N88°40'W 108')

Lot 19

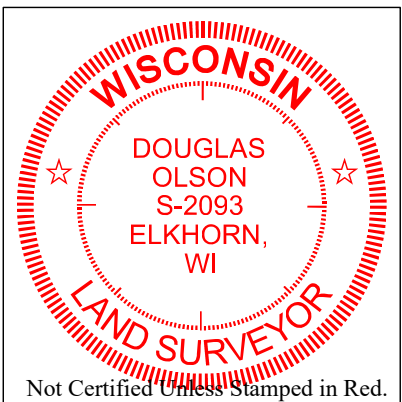

## Notes:

- This Plat of Survey is not certified unless signed and sealed in red ink.
- This survey is subject to Wisconsin lien laws. This Plat of Survey is the notice of intent to file lien. Lien waiver required.
- The Survey Date shown on this Plat of Survey is the completion date of the field work.

Copyright © 2023 by Olson Land Surveying, LLC.

All rights reserved. No part of this survey plat may be reproduced or transmitted in any form by any means - graphic, electronic, or mechanical, including photocopying, tracing, or information storage and retrieval systems - without permission in writing from Douglas G. Olson, Olson Land Surveying, LLC.

I hereby certify that I have surveyed the above described property in compliance with Chapter A-E 7 of the Wisconsin Administrative Code and that the map hereon is correct to the best of my professional knowledge and belief and shows the size and location of the property, its exterior boundaries, the location and dimensions of all visible structures thereon, boundary fences, apparent easements and roadways and visible encroachments, if any.

This survey is made for the exclusive use of the present owners of the property, and also those who purchase, mortgage or guarantee title thereto, within one year from the date hereof.

Douglas G. Olson  
Wisconsin Professional Land Surveyor - 2093

Sheet 1 of 1 Sheets

Drawing Name:

Job Reference Number  
**2023.069**

## Legend of Symbols & Abbreviations

- Found Iron Pipe
  - Found Iron Rod
  - Set Iron Pipe, 1" dia.
  - Recorded Information
  - Utility Box or Pedestal
  - Concrete Cover
  - Septic Vent
  - Asphalt Surface
  - Concrete Surface
  - Stone Retaining Wall
- N North  
S South  
E East  
W West  
In Bearings  
Degrees  
Minutes  
Seconds  
In Distances  
Feet  
Inches



45 South Wisconsin Street | P.O. Box 322  
Elkhorn, Wisconsin. 53121  
Telephone: (262) 723-3434  
Facsimile: (262) 723-8044  
Email: doug@olsonsurveying.com  
Website: www.olsonsurveying.com

Scale in Feet  
1" = 10'



Survey Date: August 31, 2023.

Revisions:

2023.069