

PLAT OF SURVEY
LOTS 19-21 OF BLOCK 12 OF WOODDALE ADDITION

LOCATED IN PART OF THE NE 1/4 OF THE NW 1/4 OF SECTION 16, TOWN 1 NORTH, RANGE 17 EAST
TOWN OF LINN, WALWORTH COUNTY, WISCONSIN

LINDEN ROAD
(66' WIDE R.O.W.)

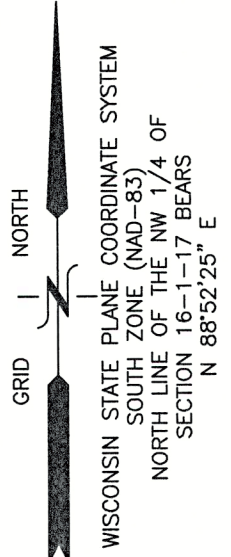

PLAT OF SURVEY
LOT 1 (19-21)
WOODDALE DRIVE

WORK ORDERED BY -
GENEVA HOMES (JOHN BAKKEN)
PO BOX 7
LAKE GENEVA, WI 53147

FARRIS, HANSEN & ASSOCIATES, INC.
ENGINEERING - ARCHITECTURE - SURVEYING
7 RIDGWAY COURT P.O. BOX 437
ELKHORN, WISCONSIN 53121
OFFICE: (262) 723-2098 FAX: (262) 723-5886

REVISIONS
5-13-23-CAH
PERMIT PLAT

5-23-23
Lower pool area 1'
Add two ret. walls

PROJECT NO.
10662.01

DATE:
4/20/2023

SHEET NO.
1 OF 1

CONSTRUCTION SEQUENCE

- 1) SILT FENCING INSTALLED
- 2) VEGETATION TO BE CLEARED
- 3) TOPSOIL STRIPPED
- 4) FOUNDATIONS DUG & POURED
- 5) WALLS BACKFILLED (WASTE EXCESS OFFSITE)
- 6) FRAMING & HOME CONSTRUCTION COMPLETED
- 7) DRIVE & LANDSCAPING COMPLETED

AREA TO BE RESTORED WITH TOPSOIL AS SOON AFTER FOUNDATION AND FRAMING AS POSSIBLE FOLLOWED WITH GRASS SEEDING AND MULCH.

AREA WITHIN SILT FENCING TO BE CLEARED OF UNDERBRUSH WITH ONLY NECESSARY LARGE TREES REMOVED.

NOTE: ALL SILT FENCING SHALL BE MAINTAINED IN A STABLE CONDITION FULLY BRACED AND STAKED TO PREVENT MOVEMENT BY RUNOFF UNTIL A DENSE TURF IS ESTABLISHED OVER ALL DISTURBED GROUND SURFACES. DURING OR AFTER EVERY STORM THEY SHALL BE CHECKED. ACCUMULATIONS OF SILT TOPSOIL AND ANY OTHER CONSTRUCTION DEBRIS SHALL BE ROUTINELY REMOVED.

LEGEND

- = IRON PIPE FOUND 1 3/8" O.D.
- = IRON REBAR FOUND 3/4" O.D.
- ⊕ = SOIL BORING
- {xxx} = RECORDED AS
- = PROPOSED SURFACE FLOW
- = PROPOSED SPOT ELEVATION

NOTE: COPIES OF THIS MAP TO WHICH THE FOLLOWING CERTIFICATE WILL APPLY SHOW THE SURVEYOR'S ORIGINAL SEAL AND SIGNATURE IN RED INK. COPIES BY ANY OTHER MEANS MAY HAVE ALTERATIONS WHICH DO NOT REPRESENT THE SURVEYOR'S WORK PRODUCT.

I HEREBY CERTIFY THAT THE ABOVE DESCRIBED PROPERTY HAS BEEN SURVEYED UNDER MY DIRECTION AND THAT THE ABOVE MAP IS A TRUE REPRESENTATION THEREOF AND SHOWS THE SIZE AND LOCATION OF THE PROPERTY AND ITS EXTERIOR BOUNDARIES. THIS SURVEY IS MADE FOR THE USE OF THE PRESENT OWNERS OF THE PROPERTY, AND ALSO THOSE WHO PURCHASE, MORTGAGE, OR GUARANTEE THE TITLE THERETO WITHIN ONE YEAR FROM THE DATE HEREOF.

DATED: 4/20/2023

REVISED 10/18/2023 TO
SHOW RESIDENCE AS BUILT.

CHRISTOPHER A. HODGES P.L.S. 2760

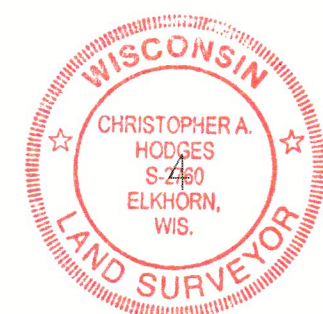

LANDS SURVEYED

45,225 S.F.
(1.04 ACRES)

RESIDENCE
LOCATED
10/9/2023

PATIO

MOUND SYSTEM

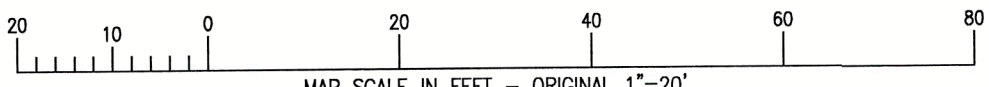

X:\Projects\10662\ACAD\10662.01\10662.01.dwg

W 00061A

172 4856