

Property Exhibit

of

Lots 8 and 9 of Edgewater Terrace,

a subdivision located in the Southwest 1/4 of Section 9,
Town 1 North, Range 17 East, Town of Linn, Walworth
County, Wisconsin.

Surveyed for:

McCormack + Etten / Architects

400 Broad Street
Lake Geneva, Wisconsin. 53147



Lot 7

Lot 8

Lot 9

**Tax Parcel
IE 00008**

**House
W4068**

**Tax Parcel
IL 900005A**

Walnut Drive

(25' Wide)

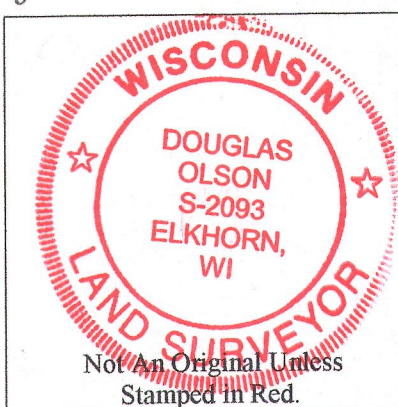

Notes:

- 1) This Property Exhibit is not an original unless signed and sealed in red ink.
- 2) This exhibit is subject to Wisconsin lien laws. This Property Exhibit is the notice of intent to file lien. Lien waiver required.

Copyright 2015 by Olson Land Surveying, LLC.

All rights reserved. No part of this survey plat may be reproduced or transmitted in any form by any means - graphic, electronic, or mechanical, including photocopying, tracing, or information storage and retrieval systems - without permission in writing from Douglas G. Olson, Olson Land Surveying, LLC.

I, Douglas G. Olson, Wisconsin Professional Land Surveyor, do hereby certify that this survey was performed by me, or under my direction in full compliance with the owner's/agent's instructions and Chapter A-E 7 of the Wisconsin Administrative Code "Minimum Standards for Property Surveys"; and that this map is an accurate representation thereof to the best of my knowledge and belief.

Douglas G. Olson
Wisconsin Professional Land Surveyor - 2093

Sheet 1 of 1 Sheets

Drawing Name:

Job Reference Number

2015.077

Legend

- Found Iron Pipe
- Recorded Information
- Utility Pole
- Utility Pedestal
- Sprinkler Head
- Asphalt Surface
- Brick Pavers
- Control Valve
- Drain
- Concrete

Olson Land Surveying, LLC

45 South Wisconsin Street * P.O. Box 322 * Elkhorn, Wisconsin. 53121

Telephone: (262) 723-3434 * Facsimile: (262) 723-8044

Email: doug@olsonsurveying.com

Scale in Feet

1" = 10'

0' 5' 10' 20'

Survey Date: October 1, 2015.

Revisions:

2015.077

IE-8

117-3922