

# Plat of Survey

of  
**Lot 3 of Certified Survey Map No. 1649,**  
 recorded in the office of the Register of Deeds for Walworth County, Wisconsin on December 14, 1987 in Volume 7 of Certified Survey Maps, on Pages 351-352, as Document No. 156418, located in West 1/2 of Section 5, Town 1 North, Range 17 East, Town of Linn, Walworth County, Wisconsin.

Surveyed for: **Keefe Real Estate, Inc.**  
 751 Geneva Parkway  
 P.O. Box 460  
 Lake Geneva, Wisconsin. 53147

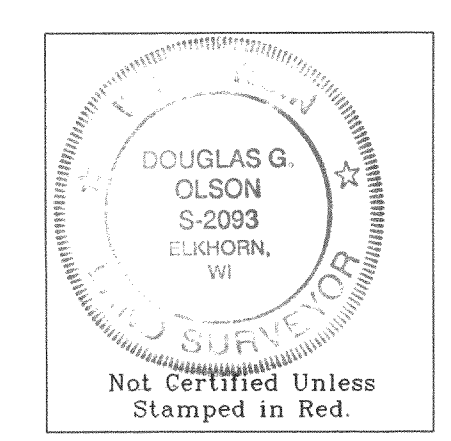
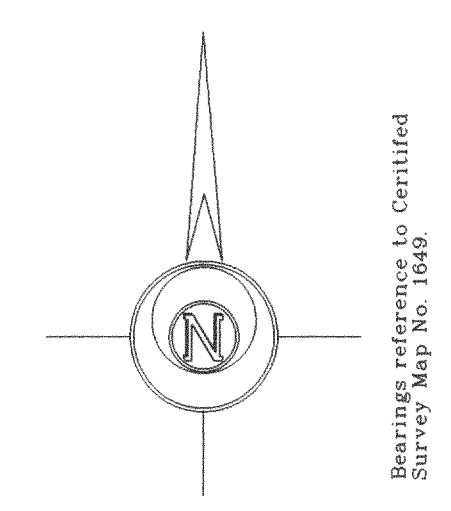

Notes: 1) This survey plat is not certified unless signed and sealed in red ink.  
 2) This survey is subject to Wisconsin lien laws. This Plat of Survey is the notice of intent to file lien. Lien waiver required.

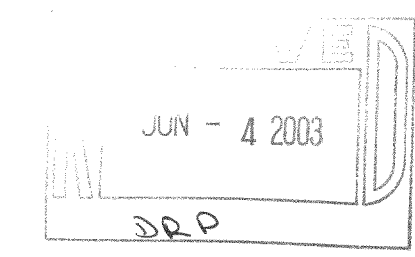

Copyright © 2003 by Jensen & Olson Land Surveying, LLC.  
 All rights reserved. No part of this survey plat may be reproduced or transmitted in any form by any means - graphic, electronic, or mechanical, including photocopying, tracing, or information storage and retrieval systems - without permission in writing from Douglas G. Olson, Jensen & Olson Land Surveying, LLC.

I hereby certify that I have surveyed the above described property and the map hereon is correct to the best of my professional knowledge and belief and shows the size and location of the property, its exterior boundaries, the location and dimensions of all visible structures thereon, boundary fences, apparent easements and roadways and visible encroachments, if any.  
 This survey is made for the exclusive use of the present owners of property, and also those who purchase, mortgage or guarantee title thereto, within one year from the date hereof.

Douglas G. Olson  
 Wisconsin Registered Land Surveyor - 2093

Survey date: May 7, 2003  
 Revisions:

Scale in Feet  
 1" = 40'

**Jensen & Olson Land Surveying, LLC**  
 45 South Wisconsin Street P.O. Box 322  
 Elkhorn, Wisconsin. 53121  
 Telephone: (262) 723-3434  
 Facsimile: (262) 723-8044

**Legend**  
 Found Concrete Monument  
 Found Iron Rail  
 Found Iron Rod  
 Found Iron Stake  
 Recorded Information  
 Survey Boundary  
 Septic Vent  
 Utility Pedestal or Box  
 Gravel Surface

Sheet 1 of 1 Sheets.  
 Job Reference Number  
**2003.062**

2003.062