

LEGAL DESCRIPTION:  
 LOT 1 OF CERTIFIED SURVEY MAP NO. 2284, BEING A PART OF THE NORTHWEST ¼ AND THE  
 SOUTHWEST ¼ OF SECTION 1, TOWN 1 NORTH, RANGE 15 EAST, IN THE TOWN OF SHARON,  
 COUNTY OF WALWORTH, STATE OF WISCONSIN.  
 LOT AREA: 5.7517 ACRES PER CSM  
 ADDRESS: N2311 USH "14"  
 TAX KEY NO: AA228400001

STATE OF WISCONSIN  
 COUNTY OF RACINE  
 The above-described property has been surveyed under my direction and  
 the above map is a correct representation thereof.  
 DATED AT: NORTH CAPE, THIS 1ST DAY OF SEPTEMBER, 2013.  
*Pete L. Bailey*  
 AMERICAN SURVEYING COMPANY, INC.  
 PETE L. BAILEY, RLS NO. 1398  
 RECERTIFIED this \_\_\_\_\_ day of \_\_\_\_\_, 2013.

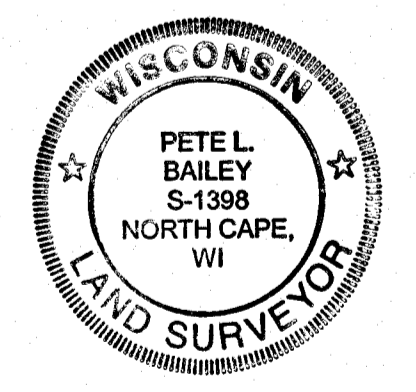

*Pete L. Bailey*



**AMERICAN SURVEYING COMPANY, INC.**  
 12207 C.T.H. "K" FRANKSVILLE, WISCONSIN 53126  
 TEL: (262) 835-4774 FAX: (262) 835-2379  
 beaufordbailey@hotmail.com

DRAWN BY:	PLB	REVISIONS:	DATE
CHECKED BY:	PLB		
PLOT SCALE:	1 = 40		
DATE:	08/30/2013		
JOB NO.:	2013083		
DWG. FILE:	JN2013144	CLIENT NO.:	04584

**TOWN OF SHARON**  
 PROJECT:  
**PLAT OF SURVEY/STAKEOUT SURVEY**  
 PREPARED FOR: GREGORY KUHLEMEYER

Sheet  
**1**  
 of  
**1**