



PLAT OF SURVEY

LOT 6, BLOCK 5 OF PRAIRIE VIEW SUBDIVISION

REC. IN CAB. C, SLIDE 195, AS DOC. NO. 623223

LOCATED IN PART OF THE NW 1/4 AND NE 1/4 OF THE NE 1/4
OF SECTION 2, TOWN 1 NORTH, RANGE 16 EAST, VILLAGE OF WILLIAMS BAY,
WALWORTH COUNTY, WISCONSIN

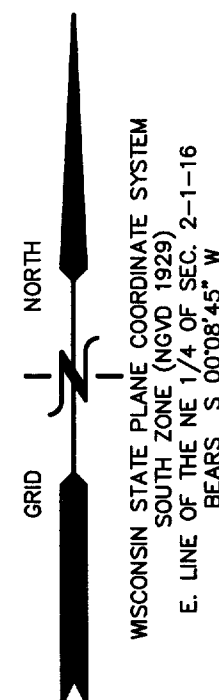

PRAIRIE VIEW ROAD
66' WIDE R.O.W. DEDICATED TO THE PUBLIC

BRIDGEWATER CIRCLE
66' WIDE R.O.W. DEDICATED TO THE PUBLIC

LOT 6
18,751 S.F.

LOT 7

* NOTE:
IF ACCESS IS FROM PRAIRIE VIEW DRIVE,
THE REAR YARD WOULD BE ALONG THE
NORTH LOT LINE, AND THE SIDE YARD
ALONG THE EAST LOT LINE.

FEB - 4 2005

NOTE: COPIES OF THIS MAP TO WHICH THE FOLLOWING CERTIFICATE WILL APPLY SHOW
THE SURVEYOR'S ORIGINAL SEAL AND SIGNATURE IN RED INK. COPIES BY ANY OTHER
MEANS MAY HAVE ALTERATIONS WHICH DO NOT REPRESENT THE SURVEYOR'S WORK
PRODUCT.

I HEREBY CERTIFY THAT THE ABOVE DESCRIBED PROPERTY HAS BEEN SURVEYED UNDER
MY DIRECTION AND THAT THE ABOVE MAP IS A TRUE REPRESENTATION THEREOF AND
SHOWS THE SIZE AND LOCATION OF THE PROPERTY, ITS EXTERIOR BOUNDARIES, THE
LOCATION OF ALL VISIBLE STRUCTURES, AND DIMENSIONS OF ALL PRINCIPLE
BUILDINGS THEREON, BOUNDARY FENCES, APPARENT EASEMENTS, ROADWAYS, AND
VISIBLE ENCROACHMENTS, IF ANY. THIS SURVEY IS MADE FOR THE USE OF THE
PRESENT OWNERS OF THE PROPERTY, AND ALSO THOSE WHO PURCHASE, MORTGAGE, OR
GUARANTEE THE TITLE THERETO WITHIN ONE YEAR FROM THE DATE HEREOF.

DATED: DECEMBER 16, 2004

PETER S. GORDON

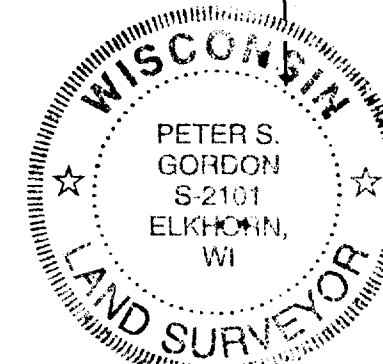

- LEGEND
- = FOUND IRON PIPE STAKE, 1 3/8" O.D.
 - = FOUND IRON REBAR STAKE, 3/4" DIA.
 - ▣ = FOUND CONCRETE COUNTY MONUMENT WITH BRASS CAP
 - = SET SOLID ROUND IRON BAR STAKE, 1 5/16" x 30" x 4.60 lbs./ft.
 - {xxx} = RECORDED AS
- ALL OTHER LOT AND OUTLOT CORNERS ARE
SET IRON REBAR STAKES, 3/4" x 24" x
1.50 lbs./ft.

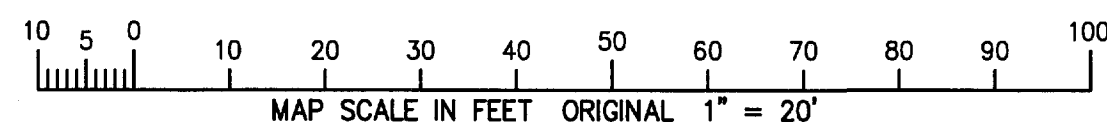

WORK ORDERED BY -
FAIRWAY, LTD.
851 PARK DRIVE, SUITE 104
LAKE GENEVA, WI 53147

FARRIS, HANSEN & ASSOCIATES, INC.
ENGINEERING - ARCHITECTURE - SURVEYING
7 RIDGWAY COURT P.O. BOX 437
ELKHORN, WISCONSIN 53121
OFFICE: (262) 723-2098 FAX: (262) 723-5886

REVISIONS

PROJECT NO.
5825.05.06
DATE:
12/16/2004
SHEET NO.
1 OF 1