

CENTER SECTION 22, TIN, RISE

**ABELL  
SURVEYING & MAPPING  
DELAVAN, WISCONSIN 53115  
414-728-6737**

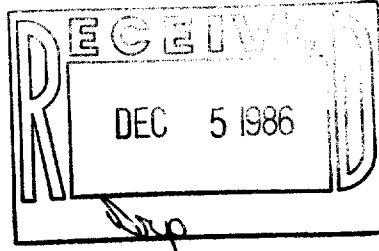

FOUND IRON ROD 0.75' SOUTH OF LINE

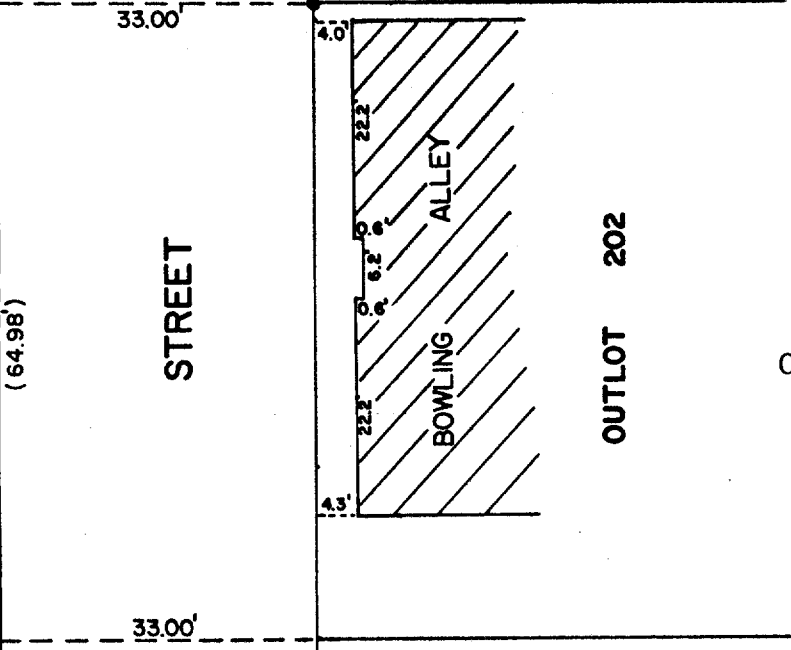

ORDERED BY: CAPWELL-BERTHELSEN  
601 LAKE AVE.  
P.O. BOX 247  
RACINE, WI 53401

PLAT OF SURVEY OF

THE SOUTHERLY RIGHT-OF-WAY LINE OF KENOSHA STREET AS DESCRIBED FOR OUTLOT 202 OF THE ASSESSOR'S PLAT, VILLAGE OF WALWORTH, WALWORTH COUNTY, WISCONSIN.

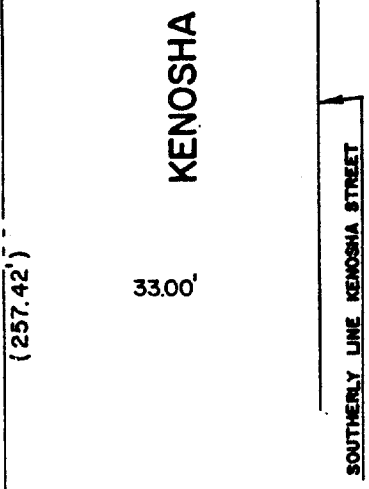

WEST 1/4 CORNER SECTION 22, TIN, RISE

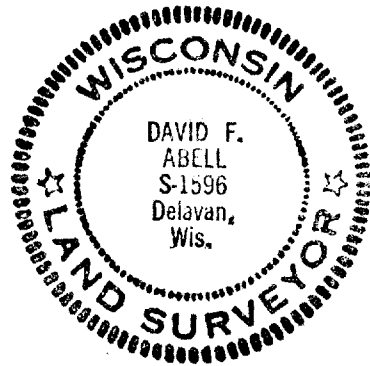

SCALE - 1"=20'

LEGEND  
( ) - RECORDED AS

I, DAVID F. ABELL, DO HEREBY CERTIFY THAT I HAVE SURVEYED THE PROPERTY HEREON DESCRIBED ACCORDING TO THE OFFICIAL RECORDS AND THAT THE PLAT HEREON IS A CORRECT REPRESENTATION OF THE PROPERTY LINES TO THE BEST OF MY KNOWLEDGE AND BELIEF.

*David F. Abell*  
DAVID F. ABELL  
WISCONSIN REGISTERED LAND SURVEYOR, S-1596

*October 16, 1986*  
DATE JOB NUMBER - 86050