

Plat of Survey

of
**Outlot 51 of the Assessor's Plat
of the Village of Walworth,**
located in the Southeast 1/4 of the Northeast 1/4 of Section 21, Town 1 North,
Range 16 East, Village of Walworth, Walworth County, Wisconsin.

Surveyed for: **Village of Walworth**
227 North Main Street
Walworth, Wisconsin. 53184

Northeast Corner
Section 21-1-16
N. 199,364.68
E. 2,377,451.17



Bearings referenced to the East line of
the Northeast 1/4 of Section 21-1-16,
recorded as N1°16'28"W in the Wis-
consin State Plane Coordinate System,
South Zone, (NAD-27).

Coordinates are referenced to the
Wisconsin State Plane Coordinate
System, South Zone, (NAD-27).

Scale in Feet
1" = 20'



Survey Date: August 27, 2018.

Revisions:

45 South Wisconsin Street | P.O. Box 322
Elkhorn, Wisconsin 53121
Telephone: (262) 723-3434
Facsimile: (262) 723-8044
Email: doug@olsonsurveying.com
Website: www.olsonsurveying.com

OLSON
LAND SURVEYING, LLC
Rural | Residential | Commercial

Legend of Symbols and Abbreviations
North Arrow
Section Corner
Found Iron Pipe
Found Cut Cross
Recorded Information
Utility Pole
Water Valve
Catch Basin
Fire Hydrant
Asphalt Surface
Concrete Surface

Sheet 1 of 1 Sheets

Drawing Name:

Job Reference Number

2018.114

2018.114

recorded as(330')
N89°40'23"E 329.35'

recorded as(330')
N89°40'17"E 330.36'
297.36'

Outlot 51
Tax Parcel
VWP 00053
0.998 Acre
43,473 Sq.Ft.
0.898 Acre
39,113 Sq.Ft.
Exclusive of R.O.W.

297.31'
S89°51'48"W 330.32'
recorded as(330')

Copyright ©2018 by Olson Land Surveying, LLC.

All rights reserved. No part of this survey plat may be reproduced or transmitted in any form by any means - graphic, electronic, or mechanical, including photocopying, tracing, or information storage and retrieval systems - without permission in writing from Douglas G. Olson, Olson Land Surveying, LLC.

I hereby certify that I have surveyed the above described property in compliance with Chapter A-E 7 of the Wisconsin Administrative Code and that the map hereon is correct to the best of my professional knowledge and belief and shows the size and location of the property, its exterior boundaries, the location and dimensions of all visible structures thereon, boundary fences, apparent easements and roadways and visible encroachments, if any.

This survey is made for the exclusive use of the present owners of the property, and also those who purchase, mortgage or guarantee title thereto, within one year from the date hereof.

Douglas G. Olson
Wisconsin Professional Land Surveyor - 2093

Notes:

- This Plat of Survey is not certified unless signed and sealed in red ink.
- This survey is subject to Wisconsin lien laws. This Plat of Survey is the notice of intent to file lien. Lien waiver required.
- The Survey Date shown on this Plat of Survey is the completion date of the field work.

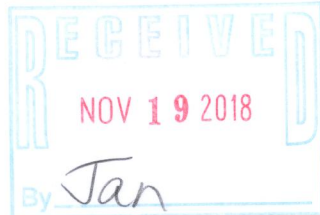
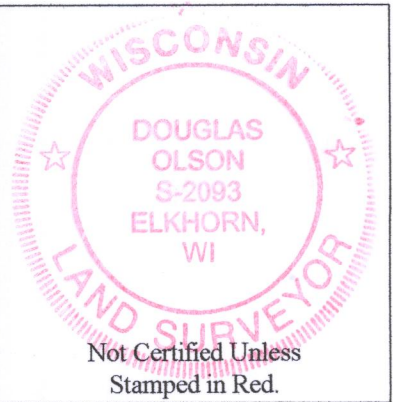

VWP-53 009-1307