

Legend

- ⊕ FOUND IRON PIPE
- ⊙ FOUND IRON ROD
- FOUND BRASS CAPPED MONUMENT
- FOUND CONCRETE ADJUSTMENT
- ⊙ CHISEL CUT IN CONCRETE
- SET IRON ROD, 24" LONG, WEIGHING 1.5 LBS./LINEAL FT., 3/4" DIA.
- SET IRON ROD, 36" LONG, WEIGHING 4.5 LBS./LINEAL FT., 1-1/8" DIA.
- RECORDED AS DIMENSION
- EXISTING FENCE
- X SET RAILROAD SPIKE
- UTILITY POLE
- UTILITY BOX
- ⊕ MANHOLE
- ⊕ CATCH BASIN
- TREE
- BUSH
- ARBORVITAE
- LIGHT POLE BASE

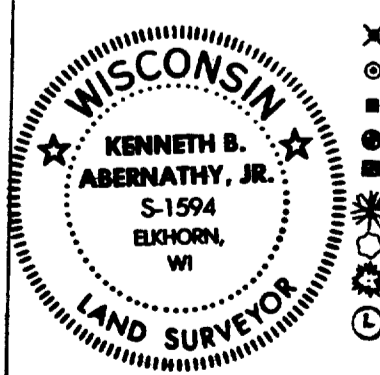

SCALE: 1" = 10 FEET

I hereby certify that the above described property has been surveyed by me or under my direction and that the above map is a true representation thereof and shows the size and location of the property, representation thereof, the location of all visible structures and dimensions of all principal buildings thereon, boundary fences, apparent easements, roadways and visible encroachments, if any.

This survey is made for the use of the present owners of the property and also those who purchase, mortgage, or guarantee the use thereof within one year from date hereof.

Kenneth B. Abernathy, Jr.
KENNETH B. ABERNATHY, JR.
 WISCONSIN REGISTERED LAND SURVEYOR,
 S-1594
 Date: July 2, 1996 Job No. 1996.605