

10

May. 13/19

Survey of west end

Stakes found at
 and at N.E. cor.
 and at N.E. cor.
 and S.E. cor.
 Measured S. from
 82.5' run transit
 on E. side Freeman
 measured over
 Booth and
 sides of Booth
 inter. of these
 on inter. of
 W. line R.R. set
 of R.R. run by
 posts still stand
 at this point

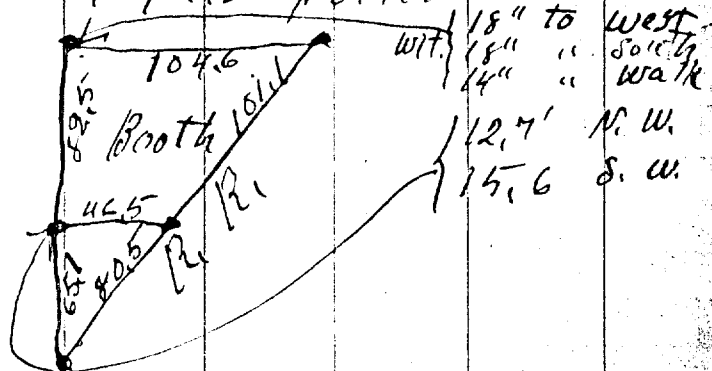

FR-13

Quoda Junction

& Booth St.

N.E. Cor. Freeman & Kossuth
 Freeman and Bond
 Freeman and Booth
 Sumner and Booth
 N.E. Cor. Booth & Freeman
 line over stakes found
 and set iron stake
 82.5' from cor. of Sumner
 run lines on both S. & N.
 and set iron stakes at
 lines with W. line R.R.
 E line of Freeman &
 iron stake. W. line
 line on old fence
 ing. Right away 48' wide

walk joint
 " " S.W.
 to elm
 " "

6-30-19