

West Street

Southwest Corner
Section 36-3-16.
N. 247.448.13
E. 2.387.045.68

S0°11'18"W 67.85'
(South 67.84')

North 204.28'

North 204.23'
(North 204.18')

Lot 44
Landmark Subdivision
Addition No. 1

Lot 45
Landmark Subdivision
Addition No. 1

Tax Parcel
YU NW 00138

0.532 Acre
23,191 Sq.Ft.
0.457 Acre
19,891 Sq.Ft.
Exclusive of R.O.W.

House
No. 834

Patio

Tax Parcel
YU NW 00139

Lot 2
C.S.M. 764

Found iron pipe shown as found
& accepted on Plat of Survey
of Tax Parcel YU NW 00139 by
Peter Gordon dated July 2, 2004.
Pipe is 1.34' S82°14'34"W of
record location.

Wood Fence corner
0.7' S. & 0.4' E. of pipe.
End of Chain Link
Fence 0.9' S. & 0.1'
E. of pipe.

End of Chain Link
Fence 0.5' S. & 0.1'
W. of pipe.

Chain Link Fence

Chain Link Fence

Chain Link Fence

Chain Link Fence

Chain Link Fence

Chain Link Fence

Chain Link Fence

Chain Link Fence

Chain Link Fence

Chain Link Fence

Chain Link Fence

Chain Link Fence

Chain Link Fence

Chain Link Fence

Chain Link Fence

Chain Link Fence

Chain Link Fence

Chain Link Fence

Chain Link Fence

Chain Link Fence

Chain Link Fence

Chain Link Fence

Chain Link Fence

Chain Link Fence

Chain Link Fence

Chain Link Fence

Chain Link Fence

Chain Link Fence

Chain Link Fence

Chain Link Fence

Chain Link Fence

Chain Link Fence

Chain Link Fence

Chain Link Fence

Chain Link Fence

Chain Link Fence

Chain Link Fence

Chain Link Fence

Chain Link Fence

Chain Link Fence

Chain Link Fence

Chain Link Fence

Chain Link Fence

Chain Link Fence

Chain Link Fence

Chain Link Fence

Chain Link Fence

Chain Link Fence

Chain Link Fence

Chain Link Fence

Chain Link Fence

Chain Link Fence

Chain Link Fence

Chain Link Fence

Chain Link Fence

Chain Link Fence

Chain Link Fence

Chain Link Fence

Chain Link Fence

Chain Link Fence

Chain Link Fence

Chain Link Fence

Chain Link Fence

Chain Link Fence

Chain Link Fence

Chain Link Fence

Chain Link Fence

Chain Link Fence

Chain Link Fence

Chain Link Fence

Chain Link Fence

Chain Link Fence

Chain Link Fence

Chain Link Fence

Chain Link Fence

Chain Link Fence

Chain Link Fence

Chain Link Fence

Chain Link Fence

Chain Link Fence

Chain Link Fence

Chain Link Fence

Chain Link Fence

Chain Link Fence

Chain Link Fence

Chain Link Fence

Notes:

- This survey plat is not certified unless signed and sealed in red ink.
- This survey is subject to Wisconsin lien laws. This Plat of Survey is the notice of intent to file lien. Lien waiver required.

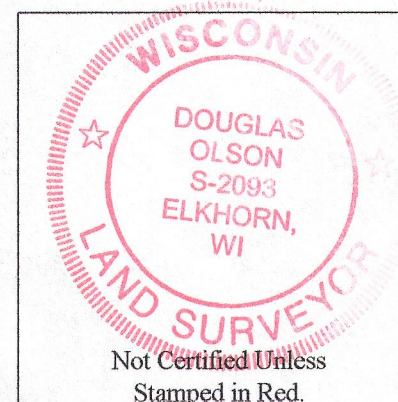

Plat of Survey

of

Lands described in a Quit Claim Deed recorded June 27, 2005 as Document No. 644712 as shown below:

A parcel of land located in the SW 1/4 of Section 36 Tsp. 3 N. R. 16 E. in the City of Elkhorn, Walworth County, Wisconsin and described as follows, to-wit: Commencing at the SW corner of said Section 36, thence S. 67.84 ft. to the center line of Walworth Street, thence N. 78° 23' E. along said center line 428.54 ft. to the place of beginning; thence N. 33.69 ft. to the N'y line of said street, thence continuing N. 204.18 ft., thence N. 78° 23' E. 100 ft., thence S. 204.18 ft. to the N'y line of Walworth Street, thence continuing S. 33.69 ft. to said center line of Walworth Street, thence S. 78° 23' W. along said center line 100 ft. to the place of beginning.

Surveyed for: **Dan & Emily Schuren**

834 West Walworth Street
Elkhorn, Wisconsin. 53121

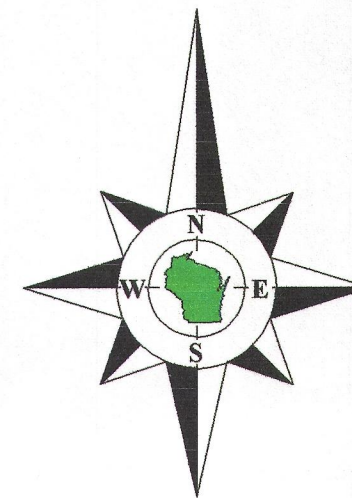

Bearings reference to previous surveys of record.

(190.77')
190.78'

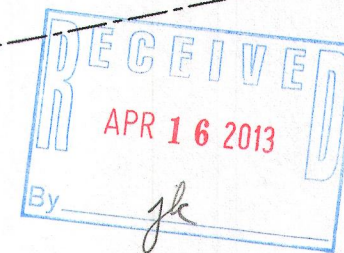

Copyright 2013 by Jensen & Olson Land Surveying, LLC.

All rights reserved. No part of this survey plat may be reproduced or transmitted in any form by any means - graphic, electronic, or mechanical, including photocopying, tracing, or information storage and retrieval systems - without permission in writing from Douglas G. Olson, Jensen & Olson Land Surveying, LLC.

I hereby certify that I have surveyed the above described property and the map hereon is correct to the best of my professional knowledge and belief and shows the size and location of the property, its exterior boundaries, the location and dimensions of all visible structures thereon, boundary fences, apparent easements and roadways and visible encroachments, if any.

This survey is made for the exclusive use of the present owners of the property, and also those who purchase, mortgage or guarantee title thereto, within one year from the date hereof.

Douglas G. Olson
Wisconsin Registered Land Surveyor - 2093

Survey Date: January 17, 2013.
Revisions:

Scale in Feet
1" = 20'



Jensen & Olson Land Surveying, LLC
45 South Wisconsin Street * P.O. Box 322 * Elkhorn, Wisconsin. 53121
Telephone: (262) 723-3434 * Facsimile: (262) 723-8044
Email: jensen.olson@elknet.net

Legend
Found County Section Corner
Found Iron Pipe
Found Iron Rod
Found Chiseled Cross
Set Iron Pipe, 1" dia.
Recorded Information
Utility Pole
Concrete Cover
Concrete Surface
Lamp

Sheet 1 of 1 Sheets

Drawing Name: G:\16-201302-201302\Plat.dwg

Job Reference Number

2013.002

2013.002

YU NW 00138 004-2381