

Plat of Survey

of

Tax Parcel YAB 00009,

located in the Southwest 1/4 of the Southwest 1/4 of Section 31, Town 3 North, Range 17 East, Town of City of Elkhorn, Walworth County, Wisconsin.

Legal Description

Lands described in a Quit Claim Deed recorded November 02, 2006 as Document No. 692660 as shown below:
Lot 1 and a strip of land in Lot 2, Block 2 of Arnold's Addition to the Village, now City of Elkhorn, described as follows: Commencing at the SW corner of said Lot 2; thence E along the S line of said Lot 2, 6.41 feet to a point; thence N 142.86 feet more or less to a point in the N line of said Lot 2, which is 6.35 feet E of the NW corner of said Lot 2; thence W along the N line of said Lot to the NW corner thereof; thence S along the W line of Lot 2 to the place of beginning. Also, a parcel of land located in Lot 2 Block 2 Arnold's Addition to City of Elkhorn described as follows to-wit: Commencing at a point on the North line of said Lot 2 located 60.28 feet W of the NE corner of said Lot 2, thence Southerly parallel to the W line of said Lot 2, 85.70 feet to the place of beginning, thence E 5 feet, thence Southwesterly in a straight line to a point on the S line of said Lot 2 which point is 60.75 feet Westerly from the Southeast corner of said Lot 2, thence N parallel to the W line of said Lot 2 to the place of beginning.

Surveyed for: The Rauland Agency, Inc.
118 Kenosha Street
Walworth, Wisconsin. 53184

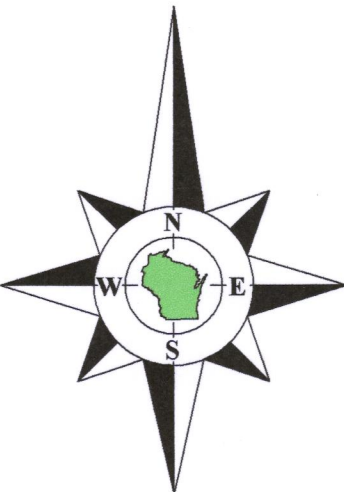

Bearings referenced to the North line of the Northwest 1/4 of Section 6-2-17, recorded as N88°53'13"E in the Wisconsin State Plane Coordinate System, South Zone, (NAD-27).

Coordinates are referenced to the Wisconsin State Plane Coordinate System, South Zone, (NAD-27).



Notes:

- 1) This Plat of Survey is not certified unless signed and sealed in red ink.
- 2) This survey is subject to Wisconsin lien laws. This Plat of Survey is the notice of intent to file lien. Lien waiver required.
- 3) The Survey Date shown on this Plat of Survey is the completion date of the field work.

Copyright ©2019 by Olson Land Surveying, LLC.

All rights reserved. No part of this survey plat may be reproduced or transmitted in any form by any means - graphic, electronic, or mechanical, including photocopying, tracing, or information storage and retrieval systems - without permission in writing from Douglas G. Olson, Olson Land Surveying, LLC.

I hereby certify that I have surveyed the above described property in compliance with Chapter A-E 7 of the Wisconsin Administrative Code and that the map hereon is correct to the best of my professional knowledge and belief and shows the size and location of the property, its exterior boundaries, the location and dimensions of all visible structures thereon, boundary fences, apparent easements and roadways and visible encroachments, if any.

This survey is made for the exclusive use of the present owners of the property, and also those who purchase, mortgage or guarantee title thereto, within one year from the date hereof.

Douglas G. Olson
Wisconsin Professional Land Surveyor - 2093

Survey Date: May 22, 2019.
Revisions:

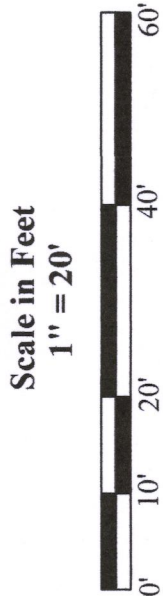

45 South Wisconsin Street | P.O. Box 322
Elkhorn, Wisconsin. 53121
Telephone: (262) 723-3434
Facsimile: (262) 723-8044
Email: doug@olsonsurveying.com
Website: www.olsonsurveying.com

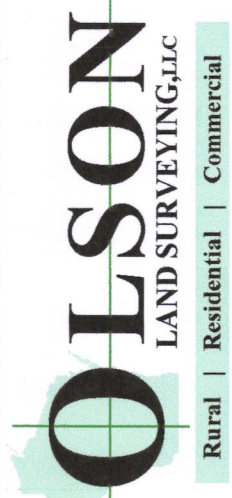

Legend of Symbols & Abbreviations

Found	County	Section	Corner
●	North	6-2-17	North
○	South	6-2-17	South
×	East	6-2-17	East
+	West	6-2-17	West
□	Found	Iron Pipe	Found
○	Recorded	Information	Recorded
○	Utility	Pole	Utility
○	Water	Valve	Water
○	Manhole	Manhole	Manhole
○	Fire Hydrant	Fire Hydrant	Fire Hydrant
○	Asphalt	Surface	Asphalt
○	Concrete	Surface	Concrete
○	Gravel	Surface	Gravel

Sheet 1 of 1 Sheets
Drawing Name
Job Reference Number
2019.053
2019.053