

SURVEYING

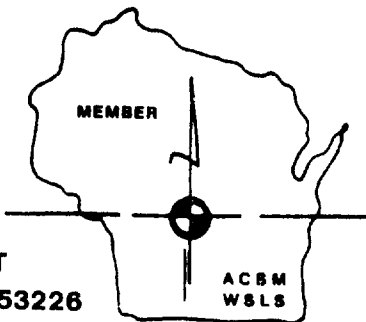

ASSOCIATES, INC.

2554 N. 100th STREET
WAUWATOSA, WISCONSIN 53226

FREDERICK W. SHIBILSKI RLS
(414) 257-2212

PLAT OF SURVEY

-of-

Commencing at a point 89 rods North of the Southeast corner of Section 19, Township 4 North, Range 18 East, run thence West 18 rods, thence North 4 rods, thence East 18 rods, thence South 4 rods to the place of beginning. Also that parcel of land described as follows: The West 80 feet to the following described parcel, to-wit: That certain piece or parcel of land lying, situate and being in the Town of East Troy, Walworth County, State of Wisconsin, Section 19, T. 4 N. R. 18 E. Commencing at a point 84 rods N. of the Southeast corner of Section 19, running thence W. 18 rods; thence N. 5 rods; thence E.

Legal continued on following page.

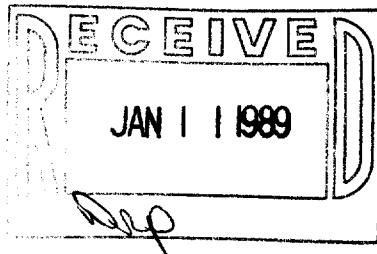
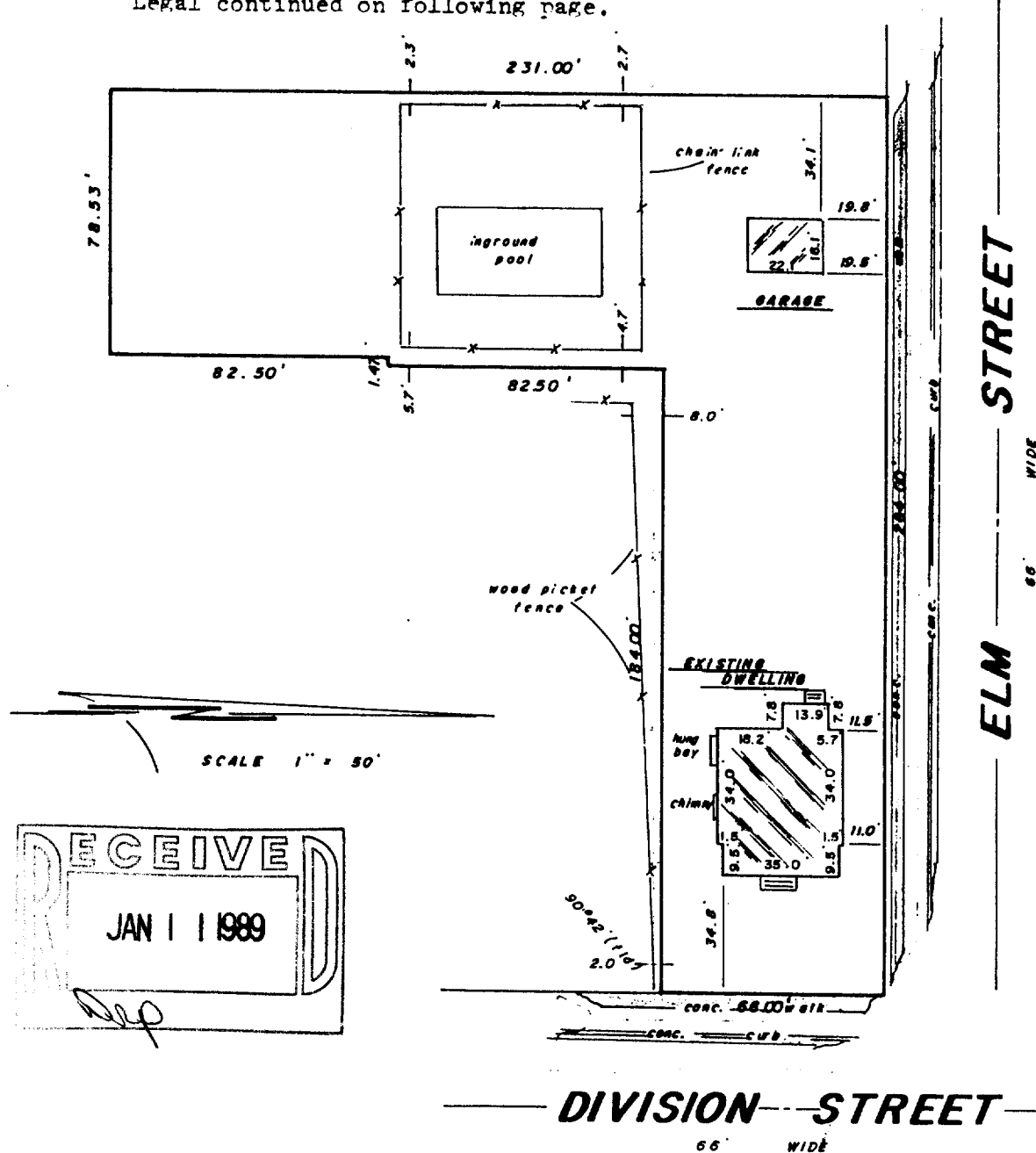

ELM STREET
66' WIDE

DIVISION STREET
66' WIDE

Surveyed for AMERICAN MORTGAGE CORP. OF WI

"I hereby certify that I have surveyed the above described property and that the above map is a true representation thereof and shows the size and location of the property, its exterior boundaries, the location of all visible structures and dimensions of all principal buildings thereon, boundary fences, apparent easements, roadways and encroachments, if any."

"This survey is made for the use of the present owners of the property, and also those who purchase, mortgage, or guarantee the title thereto within one year from date hereof."

MONUMENTATION BY WRITTEN AGREEMENT WITH THE ABOVE NAMED CLIENT (HAS NOW) BEEN WAIVED IN ACCORDANCE WITH A-E 5.01 (1) (b) OF THE WISCONSIN ADMINISTRATIVE CODE



"THIS IS NOT AN ORIGINAL SURVEY UNLESS THIS SEAL IS RED."

Frederick W. Shibilski
WISCONSIN REGISTERED LAND SURVEYOR

NOV. 18, 1986
DATE

bjw / dll
FIELD WORK BY

m dn
DRAWN BY

14746
JOB NUMBER

SHEET 1 of 2

3-306

REMAP 74. ROL 26

SURVEYING

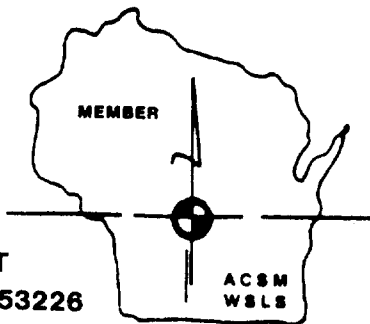

ASSOCIATES, INC.

2554 N. 100th STREET
WAUWATOSA, WISCONSIN 53226

FREDERICK W. SHIBILSKI RLS
(414) 257-2212

PLAT OF SURVEY
-of-

18 rods; thence S. 5 rods to the place of beginning, being a part of the North lot formerly owned by Joseph Stillwell.

ALSO: All that certain piece or parcel of land lying situate and being in the Village of East Troy, Walworth County, Wisconsin, being a part of Lot 1, Block 3, and adjoining land, described as follows, to-wit: Commencing at a point 5 rods N. of the SE corner of Lot 1 in Block 3 and running thence 5 rods N., thence W. 16 rods, thence 5 rods S., thence 16 rods E. to place of beginning. EXCEPTING THEREFROM land conveyed in Warranty Deed dated October 8, 1971 and recorded in the office of the Register of Deeds for Walworth County, Wisconsin on October 12, 1971 in Volume 57 of Records, page 255, as Document No. 641940.

Survey location: 1985 Division Street
Buyer: Donald E. & Deborah Mueller



Surveyed for: AMERICAN MORTGAGE CORP. OF WI

"I hereby certify that I have surveyed the above described property and that the above map is a true representation thereof and shows the size and location of the property, its exterior boundaries, the location of all visible structures and dimensions of all principal buildings thereon, boundary fences, apparent easements, roadways and encroachments, if any.

"This survey is made for the use of the present owners of the property, and also those who purchase, mortgage, or guarantee the title thereto within one year from date hereof."

MONUMENTATION BY WRITTEN AGREEMENT WITH THE ABOVE NAMED CLIENT (HAS ~~BEEN~~) BEEN WAIVED IN ACCORDANCE WITH A-E 8.01 (1) (b) OF THE WISCONSIN ADMINISTRATIVE CODE

"THIS IS NOT AN ORIGINAL SURVEY UNLESS THIS SEAL IS RED."

SHEET 2 of 2

WISCONSIN REGISTERED LAND SURVEYOR

NOV. 18, 1986
DATE

bjm/dll
FIELD WORK BY

mdn
DRAWN BY

14746
JOB NUMBER