

Plat of Survey

of
Lots 2 & 3 of Certified Survey Map No. 841,

recorded in Vol. 4 of Certified Survey Maps of Walworth County on Page 24 and located in the Northeast 1/4 and the Northwest 1/4 of the Northeast 1/4 Section 17, Town 2 North, Range 16 East, City of Delavan, Walworth County, Wisconsin.

EXCEPTING THEREFROM property conveyed to the State of Wisconsin, Department of Transportation as described in Vol. 347 on page 399 as Document No. 117041 and as described on a Quit Claim Deed recorded in Vol. 354 on page 153 as Document No. 120871.

Surveyed for: **Bonded Fibers Midwest, Inc.**
1450 Racine Street
Delavan, Wisconsin. 53115

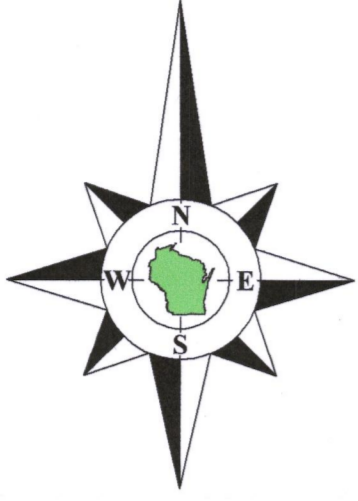

Bearings referenced to the North line of the Northeast 1/4 of Section 17-2-16, recorded as N89°22'20"E in the Wisconsin State Plane Coordinate System, South Zone, (NAD-27).

Coordinates are referenced to the Wisconsin State Plane Coordinate System, South Zone, (NAD-27).

North 1/4 Corner
Section 17-2-16
N. 236,069.37
E. 2,368,729.26

North line of the Northeast 1/4 of Section 17-2-16.
N89°22'20"E 2747.77'
recorded as (N89°22'20"E 2747.77') State Plane

Northeast Corner
Section 17-2-16
N. 236,399.47
E. 2,371,476.81

Racine Street / State Trunk Highway 11
(Width Varies)

Total Area
5.646 Acres
245,958 Sq. Ft.

Part of Lot 2 Tax Parcel XA 84100002
3.824 Acres
166,587 Sq. Ft.

Part of Lot 3 Tax Parcel XA 84100003
1.822 Acres
79,371 Sq. Ft.

Tax Parcel XWUP 00196

Tax Parcel XWUP 00196C

Tax Parcel XWUP 00179A

Tax Parcel XWUP 00179A

Building No. 1440

Building No. 1488

Building No. 1450

Trailer Parking Area

Trailer Parking Area

Trailer Parking Area

Trailer Parking Area

Trailer Parking Area

Trailer Parking Area

Trailer Parking Area

Trailer Parking Area

Trailer Parking Area

Trailer Parking Area

Trailer Parking Area

Trailer Parking Area

Trailer Parking Area

Trailer Parking Area

Trailer Parking Area

Trailer Parking Area

Trailer Parking Area

Trailer Parking Area

Trailer Parking Area

Trailer Parking Area

Lot 1 C.S.M. 841

Building No. 1440

Building No. 1440

Tax Parcel XWUP 00179A

Legend of Symbols & Abbreviations

- Found County Section Corner
- Found Iron Pipe
- Found Iron Rod
- Set Iron Pipe, 1" dia.
- Recorded Information
- Utility Pole
- Utility Pedestal
- Manhole
- Water Valve
- Fire Hydrant
- Asphalt Surface
- Concrete Surface
- Gravel Surface
- Catch Basin
- Light Pole or Light
- Gas Cover

- N North
- S South
- E East
- W West
- In Degrees
- In Minutes
- In Seconds
- In Feet
- In Inches
- No. Number
- NW Northwest
- NE Northeast
- SW Southwest
- SE Southeast
- Di. Diameter



45 South Wisconsin Street | P.O. Box 322
Elkhorn, Wisconsin. 53121
Telephone: (262) 723-3434
Facsimile: (262) 723-8044
Email: doug@olsonsurveying.com
Website: www.olsonsurveying.com

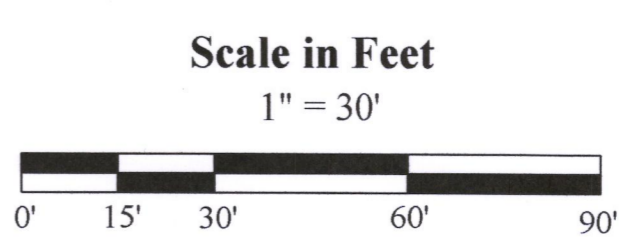

Survey date: March 28, 2018.
Revisions:
XA 841-2 002-2648
XA 841-3

Copyright © 2018 by Olson Land Surveying, LLC.
All rights reserved. No part of this survey plat may be reproduced or transmitted in any form by any means - graphic, electronic, or mechanical, including photocopying, tracing, or information storage and retrieval systems - without permission in writing from Douglas G. Olson, Olson Land Surveying, LLC.

I hereby certify that I have surveyed the above described property in compliance with Chapter A-E 7 of the Wisconsin Administrative Code and that the map hereon is correct to the best of my professional knowledge and belief and shows the size and location of the property, its exterior boundaries, the location and dimensions of all visible structures thereon, boundary fences, apparent easements and roadways and visible encroachments, if any.
This survey is made for the exclusive use of the present owners of the property, and also those who purchase, mortgage or guarantee title thereto, within one year from the date hereof.

Douglas G. Olson
Wisconsin Professional Land Surveyor - 2093

- Notes:**
- This Plat of Survey is not certified unless signed and sealed in red ink.
 - This survey is subject to Wisconsin lien laws. This Plat of Survey is the notice of intent to file lien. Lien waiver required.
 - The Survey Date shown on this Plat of Survey is the completion date of the field work.

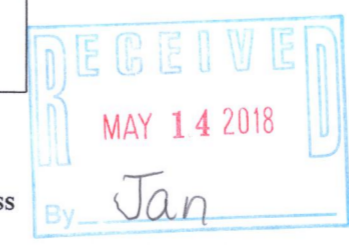
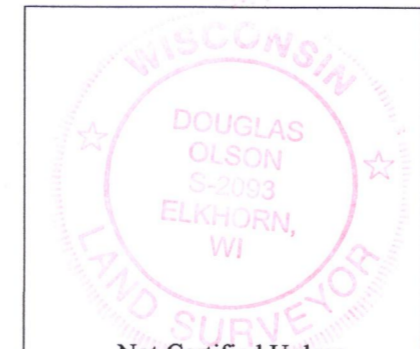

2018.015

Sheet 1 of 1 Sheets
Drawing Name:
Job Reference Number
2018.015