

WALWORTH COUNTY CERTIFIED SURVEY MAP #

RESUBDIVISION OF LOT 1
CERTIFIED SURVEY MAP NO. 2254
WALWORTH COUNTY, WISCONSIN

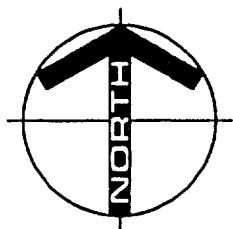
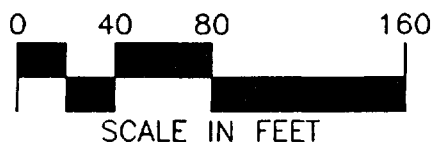

MONUMENTS

- SET 1" X 24" IRON PIPES
- FOUND MONUMENTS (PIPE, ROD, ETC...)

ALL SET MONUMENTS HAVE A PLASTIC CAP STAMPED S-1662.

BEARINGS

Bearings are Azimuths referenced to the South line of the NE 1/4 of Section 13, T 2 N, R 15 E, as assumed 268°19'23".

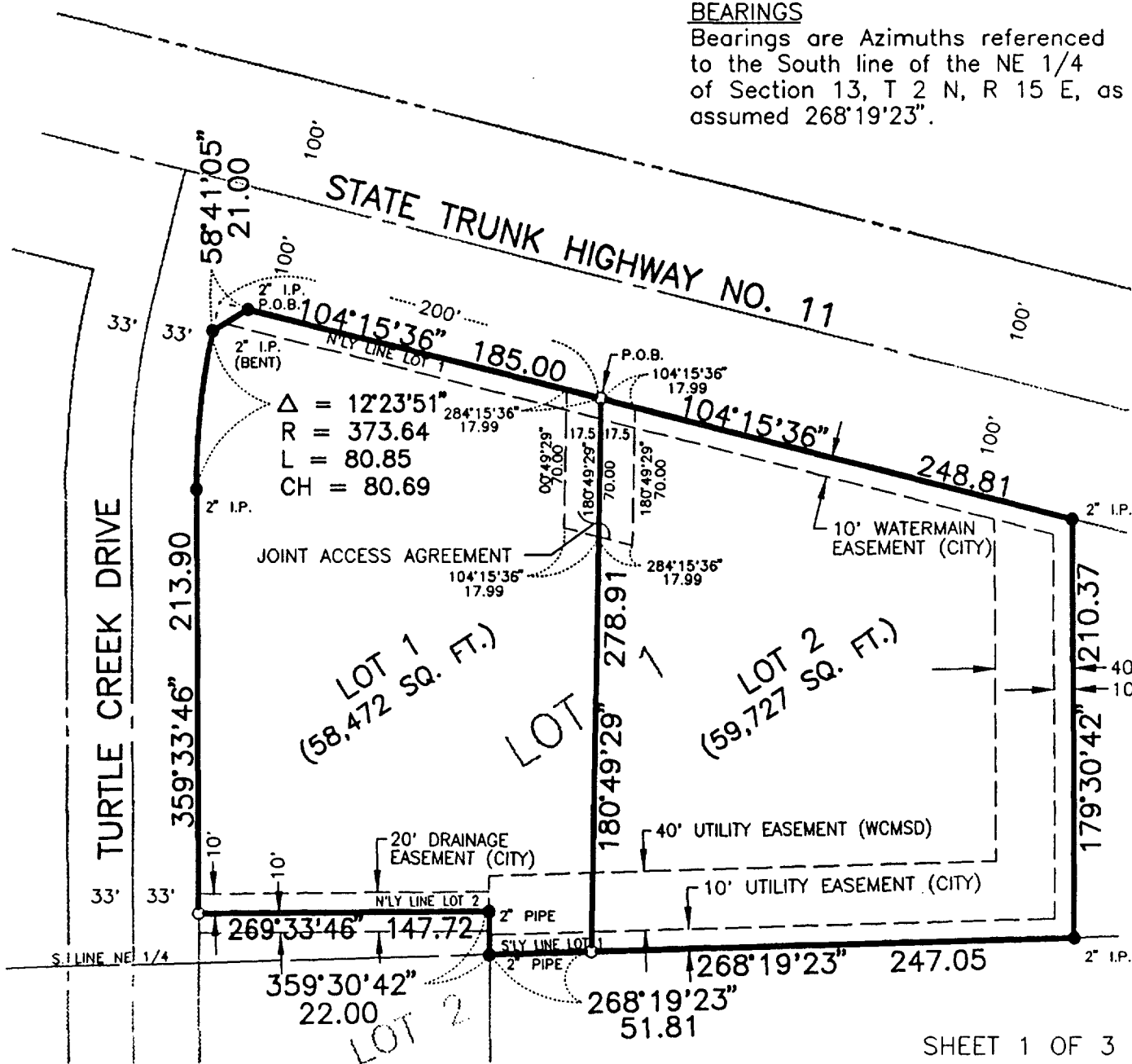

SHEET 1 OF 3

PROJECT NUMBER 4824-95

DATE OF SURVEY 11/30/95

SURVEYED BY R. MASSEY

SURVEYED FOR CASEY'S

RESUBDIVISION OF LOT 1
CERTIFIED SURVEY MAP
MAP NO. 2254
WALWORTH COUNTY, WISCONSIN

ENGINEERS • ARCHITECTS
SURVEYORS • PLANNERS
LANDSCAPE ARCHITECTS

717 3RD AVENUE SE
ROCHESTER, MN 55904
507-288-6464

MASON CITY, IOWA
515-424-0351



NA-2254-1

002-1479

WALWORTH COUNTY CERTIFIED SURVEY MAP #

RESUBDIVISION OF LOT 1
CERTIFIED SURVEY MAP NO. 2254
WALWORTH COUNTY, WISCONSIN

SURVEYOR'S CERTIFICATE

STATE OF MINNESOTA
COUNTY OF OLMSTED

I, Donald R. Borcharding, Registered Land Surveyor, hereby certify that by order of Casey's General Store's Inc., Ankeny, Iowa, I have surveyed, divided, and mapped a tract of land in the Northeast Quarter of Section 13, Township 2 North, Range 15 East, City of Delavan, Walworth County, Wisconsin, more fully described as follows:

That part of Lot 1, Certified Survey Map No. 2254, according to the map thereof on file in Volume 11, Page 50, in the office of the Register of Deeds, Walworth County, Wisconsin, more particularly described as follows:

Beginning at the most northerly corner of said Lot 1; thence easterly on an assumed azimuth from north of 104 degrees 15 minutes 36 seconds along the northerly line of said Lot 1, a distance of 433.81 feet to the northeast corner of Lot 1; thence southerly 179 degrees 30 minutes 42 seconds azimuth along the east line of said Lot 1 a distance of 210.37 feet to the southeast corner of said Lot 1; thence westerly 268 degrees 19 minutes 23 seconds azimuth along the south line of said Lot 1 a distance of 298.86 feet to the easterly line of Lot 2 said Certified Survey Map No. 2254; thence northerly 359 degrees 30 minutes 42 seconds azimuth along said easterly line 22.00 feet to the north-east corner of said Lot 2; thence westerly 269 degrees 33 minutes 46 seconds azimuth along the north line of said Lot 2, a distance of 147.72 feet to the easterly right-of-way line of Turtle Creek Drive; thence northerly 359 degrees 33 minutes 46 seconds azimuth along said easterly right-of-way line 213.90 feet; thence northerly 80.85 feet along said easterly right-of-way line on a tangential curve concave easterly, having a radius of 373.64 feet, and a central angle of 12 degrees 23 minutes 51 seconds; thence northeasterly 58 degrees 41 minutes 05 seconds azimuth along said easterly right-of-way line 21.00 feet to the point of beginning.

Said tract contains 118,017 square feet more or less.

I further certify that I have complied with Chapter 236.34 of the Wisconsin Statutes and the City of Delavan Subdivision Regulations in surveying and mapping the same and that the accompanying map is a true and correct representation of the external boundaries of the land surveyed, to the best of my knowledge and belief.

Dated this ____ Day of ____, 1995.

Donald R. Borcharding S-1662

SHEET 2 OF 3

PROJECT NUMBER 4824-95

DATE OF SURVEY 11/30/95

SURVEYED BY R. MASSEY

SURVEYED FOR CASEY'S

RESUBDIVISION OF LOT 1
CERTIFIED SURVEY MAP
MAP NO. 2254
WALWORTH COUNTY, WISCONSIN

ENGINEERS • ARCHITECTS
SURVEYORS • PLANNERS
LANDSCAPE ARCHITECTS

717 3RD AVENUE SE
ROCHESTER, MN 55904
507-288-6464

MASON CITY, IOWA
515-424-0351

**YAGGY
COLBY
ASSOCIATES**

WALWORTH COUNTY CERTIFIED SURVEY MAP #

RESUBDIVISION OF LOT 1
CERTIFIED SURVEY MAP NO. 2254
WALWORTH COUNTY, WISCONSIN

CITY COUNCIL APPROVAL

Resolved by the Common Council of the City of Delavan, Wisconsin, that the Certified Survey Map, attached hereto and filed with the City of Delavan.

Dated this _____ day of _____, 1995.

Approved _____
Ronald Henriott, Mayor

Attest: _____
Betty Wassel, City Clerk

I hereby certify that the foregoing is a Resolution adopted by the Common Council of the City of Delavan at a regular meeting, a quorum being present on the ____ day of _____, 1995.

CITY OF Delavan

Betty Wassel
City Clerk

STATE OF WISCONSIN
COUNTY OF WALWORTH

Received the _____ day of _____
A.D. 1995 at _____ O'clock _____ and
recorded in Volume _____ of Surveys, Page

Walworth County Register of Deeds

SHEET 3 OF 3

PROJECT NUMBER 4824-95

DATE OF SURVEY 11/30/95

SURVEYED BY R. MASSEY

SURVEYED FOR CASEY'S

RESUBDIVISION OF LOT 1
CERTIFIED SURVEY MAP
MAP NO. 2254
WALWORTH COUNTY, WISCONSIN

ENGINEERS • ARCHITECTS
SURVEYORS • PLANNERS
LANDSCAPE ARCHITECTS

717 3RD AVENUE S.E.
ROCHESTER, MN 55904
507-288-6464

MASON CITY, IOWA
515-424-0351

YAGGY
COLBY
ASSOCIATES

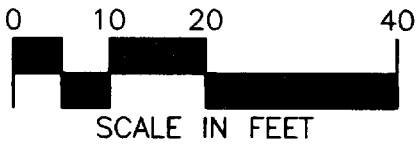

STATE TRUNK HIGHWAY NO. 11

938

937

936

935

$\Delta = 12^{\circ}23'51''$
 $R = 373.64$
 $L = 80.85$
 $CH = 80.69$

$58^{\circ}41'05''$
 21.00

RING 937.84
 INV. 923.0

185.00

$104^{\circ}15'36''$

SIGN POST

ROW OF BOXELDERS

GRAVEL

2-6' BOXELDER

15' ELM

LANDSCAPING
 STONE REF. WALL

2-4" PINES
 4" POPLAR

2" I.P.

8" SAN. S.

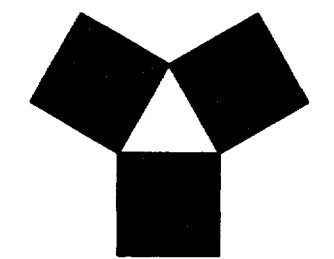

**YAGGY
 COLBY
 ASSOCIATES**

ENGINEERS • ARCHITECTS
 SURVEYORS • PLANNERS
 LANDSCAPE ARCHITECTS

717 THIRD AVENUE SOUTHEAST
 ROCHESTER, MINNESOTA 55904
 507-288-6464
 FAX 507-288-5050

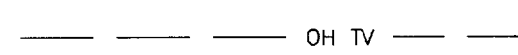
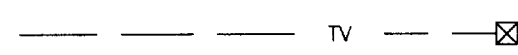
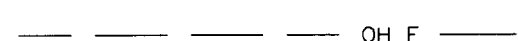
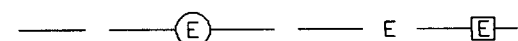
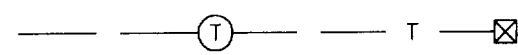
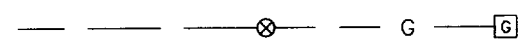
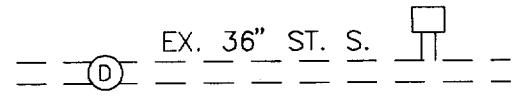
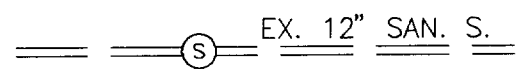
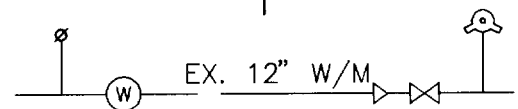
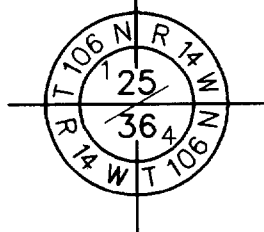
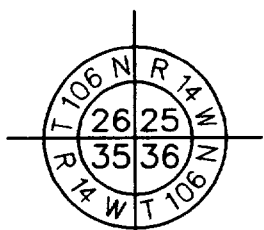
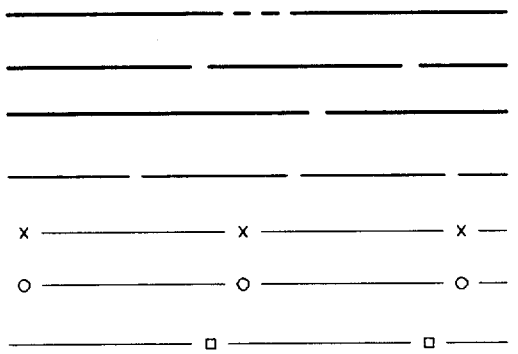

RIGHT OF WAY LINE, PROPERTY LINE
QUARTER SECTION LINE
SECTION LINE
SIXTEENTH SECTION LINE
BARBED WIRE FENCE
CHAIN-LINK FENCE
WOODEN FENCE
TREE LINE
1/2" REBARS
3/4" IRON PIPES
FOUND MONUMENTS (PIPE, ROD, ETC..)
NO MONUMENTS FOUND OR SET

SECTION CORNER MARKER

QUARTER SECTION MARKER

EXISTING WATER MAIN, WATER SHUTOFF MANHOLE, REDUCER, GATE VALVE AND HYDRANT

EXISTING WATER SHUT OFF

EXISTING SANITARY MANHOLE AND LINE

EXISTING STORM SEWER MANHOLE, LINE AND CATCH BASIN OR INTAKE

EXISTING CATCH BASIN OR INTAKE

EXISTING UNDERGROUND GAS LINE, VALVE AND METER

EXISTING UNDERGROUND TELEPHONE MANHOLE, LINE AND PEDESTAL

EXISTING OVERHEAD TELEPHONE

EXISTING UNDERGROUND ELECTRIC MANHOLE, LINE AND TRANSFORMER

EXISTING OVERHEAD ELECTRIC

EXISTING UNDERGROUND TELEVISION LINE AND PEDESTAL

EXISTING OVERHEAD TELEVISION LINE

